

# Installationsanleitung Snap-In für SC-RJ / E2000™ Compact

## Installation guide Snap-In for SC-RJ / E2000™ Compact

### Instructions de montage Snap-In pour SC-RJ / E2000™ Compact

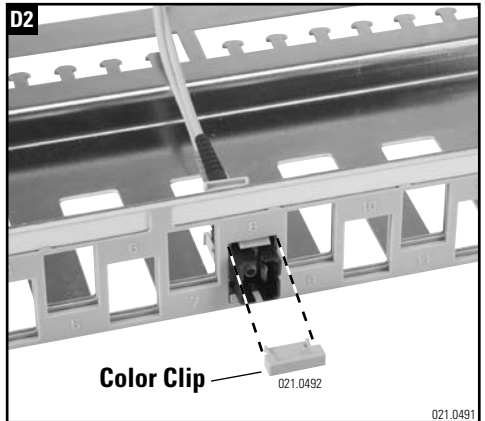

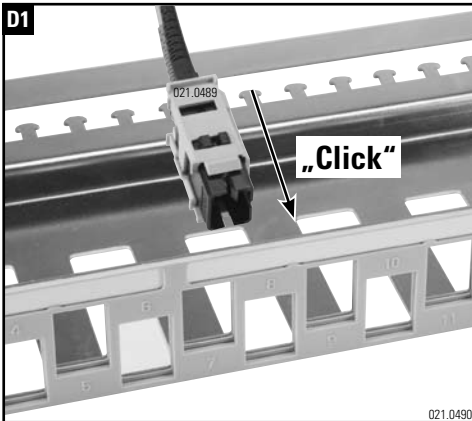
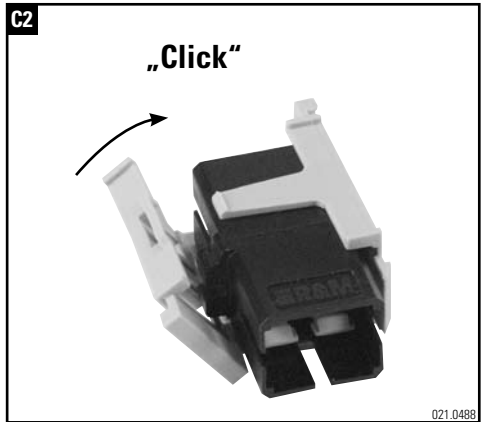
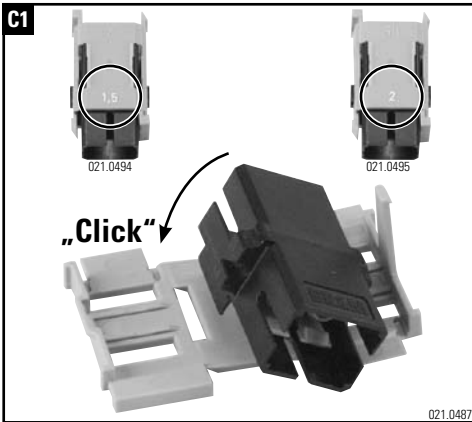
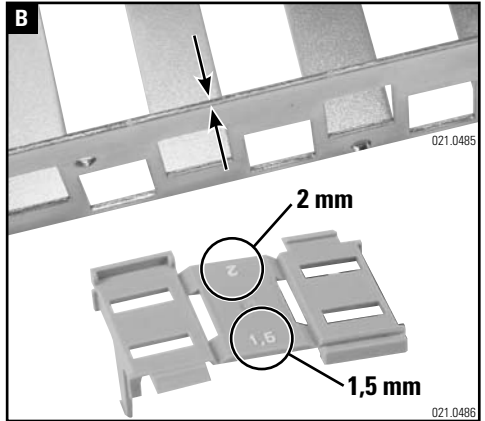
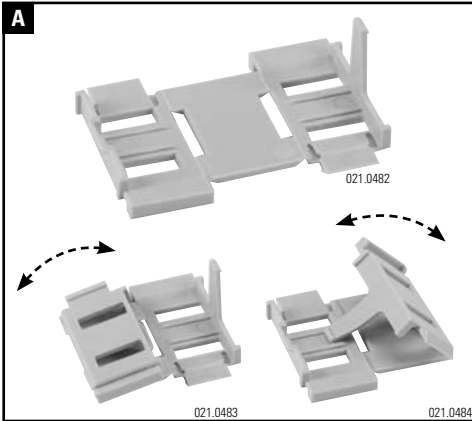
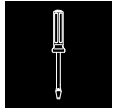
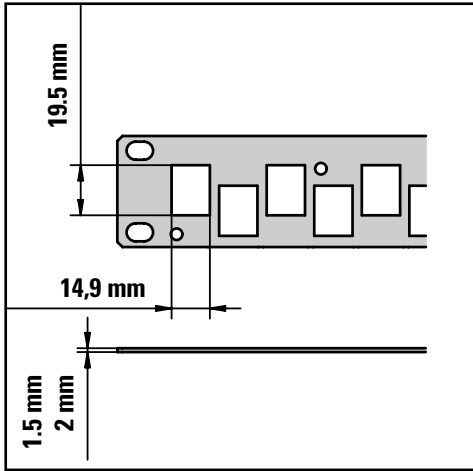

## Headquarters

### Switzerland

Reichle & De-Massari AG

Binzstrasse 32

CHE-8620 Wetzikon

Telephone HQ +41 (0)44 933 81 11

Telefax HQ +41 (0)44 930 49 41

E-Mail [info@rdm.ch](mailto:info@rdm.ch)

[www.rdm.com](http://www.rdm.com)

**R&M**