



A Kabelvorbereitung / Cable preparation

35 mm 0° 40 mm 90° 0° 90° 6 - 8 mm 12 - 14 mm

021.2295/021.2296/021.2300/021.2301/021.2302

B1 Kabel ausrichten / Cable orientation

Schirmlanze am beschriebenen Ort einführen.
 Insert bayonet where indicated.

Kabelende 1
Cable end 1

Kabelende 2
Cable end 2

021.2306.1/030.6105/030.6106

B2 Schirmlanze einführen / Shield bajonett insertion

1 2 3

021.2306.1/021.2360.1/023.0285

B3 Position Schirmlanze / Position shield bajonett

S-FTP/F-FTP SF-UTP F-UTP

Schirmlanze / Bayonet

020.1128.1/020.1130.1/021.2360.1/030.1099

C1 Kabel aufschieben / Insert cable

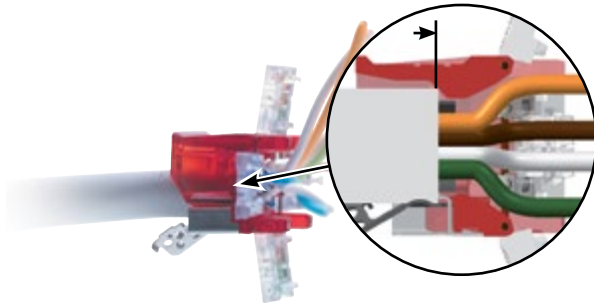

Kabel bis zum Anschlag einführen.

Insert cable as far as possible.

021.2309/021.2402

C2 Kabeleinlass varianten / Cable entry variants

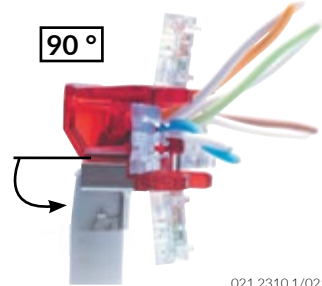
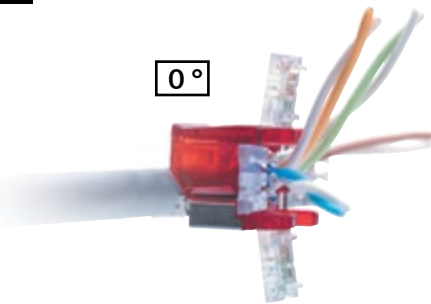

021.2310.1/021.2311

D1 Paar ausrichten / Wire pair alignment

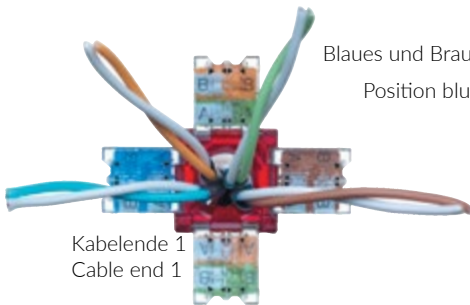

Blaues und Braunes Paar positionieren.
Position blue and brown pairs.

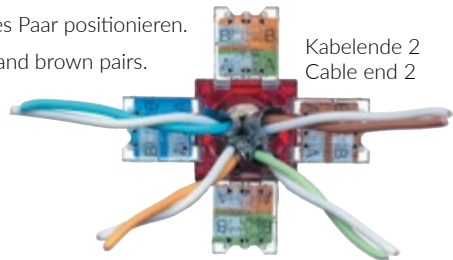

021.2303/021.2304

D2 Ein Paar kreuzen / Cross over one pair

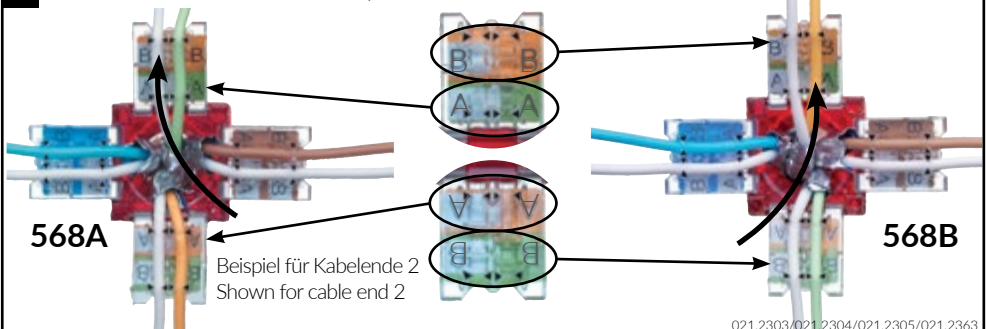

021.2303/021.2304/021.2305/021.2363

E Adern einlegen / Insert wire

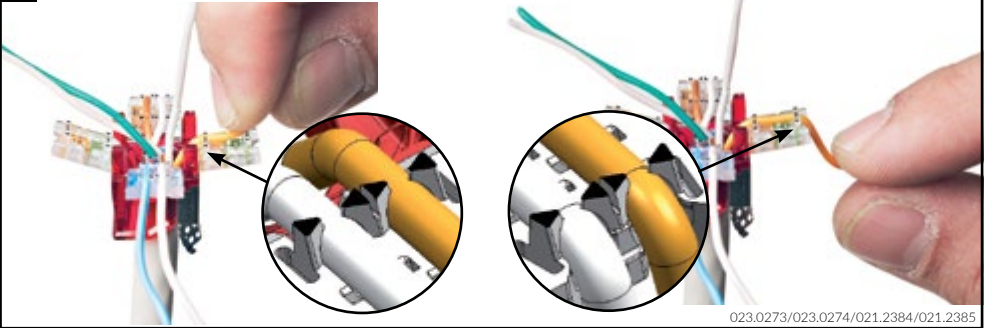

023.0273/023.0274/021.2384/021.2385

F Teile ausrichten und zusammen fügen / Align and mount parts

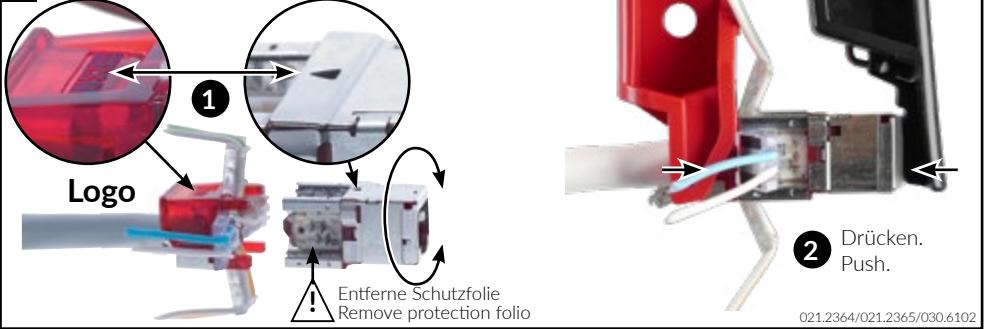

021.2364/021.2365/030.6102

G Deckel beschalten / Terminate levers

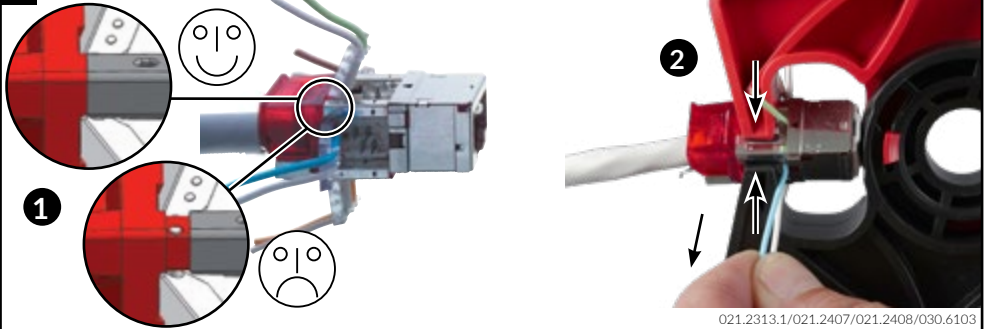

021.2313.1/021.2407/021.2408/030.6103

H1 Schirmhülle montieren / Mount shield covers

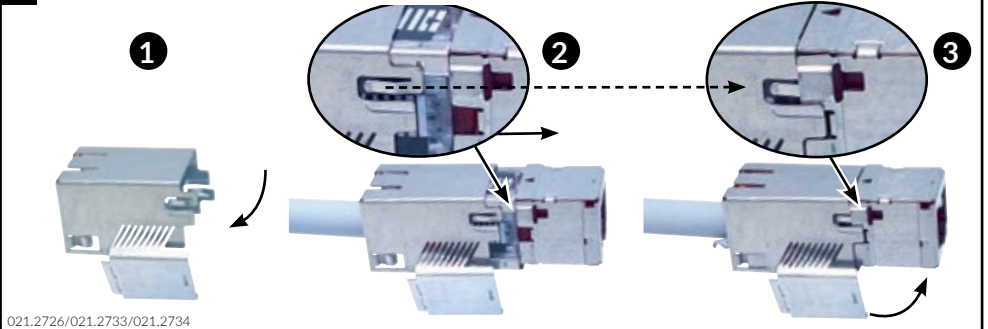

021.2726/021.2733/021.2734

H2 Schirmhülle schließen / Close shield covers

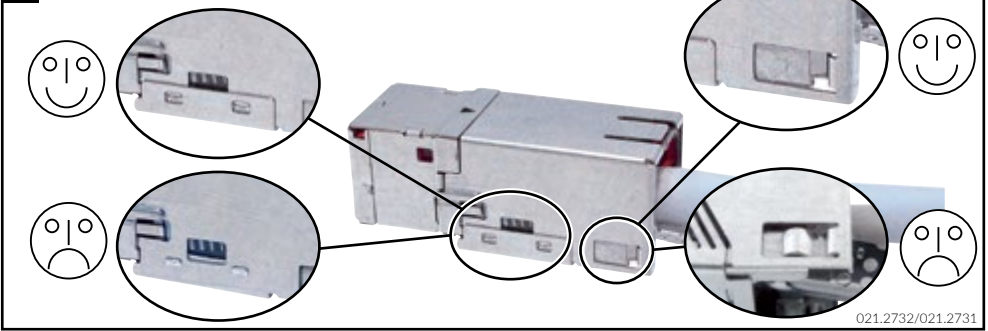

021.2732/021.2731

I Zugentlastung anbringen / Mount strain relieve

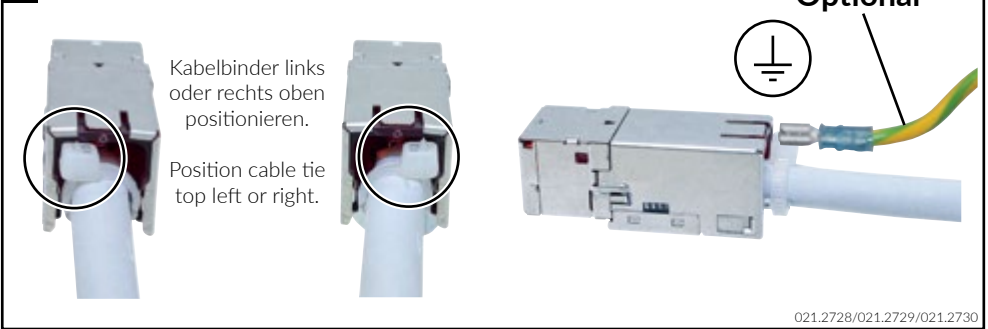

021.2728/021.2729/021.2730

Demontage

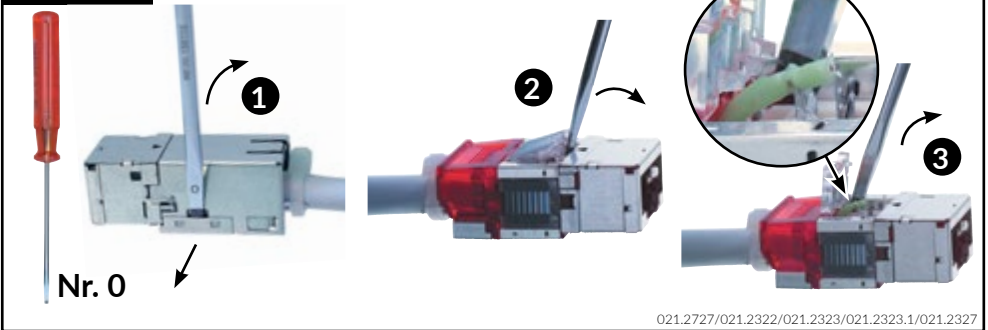

021.2727/021.2322/021.2323/021.2323.1/021.2327

Demontage

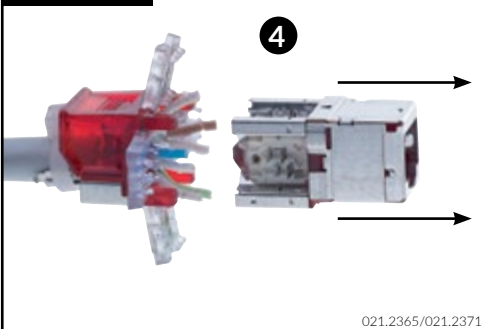

021.2365/021.2371

Please note:

This guide shows the best practices for installation **ONLY**. R&M expressly disclaims all liability for any damage to material, equipment, and for any injury or death. Legal health and safety regulations should have priority over best practices as shown in this guide. R&M does not guarantee this guide to be free of errors. Products included may vary from products shown. Please exercise caution.



R&M

Headquarters

Switzerland

Reichle & De-Massari AG

Binzstrasse 32

CHE-8620 Wetzikon

Tel HQ +41 (0)44 933 81 11

Fax HQ +41 (0)44 930 49 41

E-Mail hq@rdm.com

www.rdm.com