

**A1**

**FO Field LC**

**FO Field Patchset**

**A2**

**Kabel / cable**  
 All 600µm,  
 900µm semi-tight &  
 loose-tube buffer

**Loose Tube**

Coated Optical Fiber

**Kabel / cable**  
 900µm tight buffer

**Tight Buffer**

Buffer Layers  
 Apply Directly Over Fiber Coating

021.3456 / 021.3457

**A2 Kontrolle / Control**

021.3147 / 021.3148

**A3 Prüfmittel / Testing equipment**

Adapter & Red  
 Light Source  
 R504313

Adapter  
 1.25mm & 2.5mm  
 R823872

Multimode - R813284  
 Singlemode - R813285

021.3017 / 021.3150 / 021.3161

**A4**

021.3182 / 021.3019

**B1**

021.3183

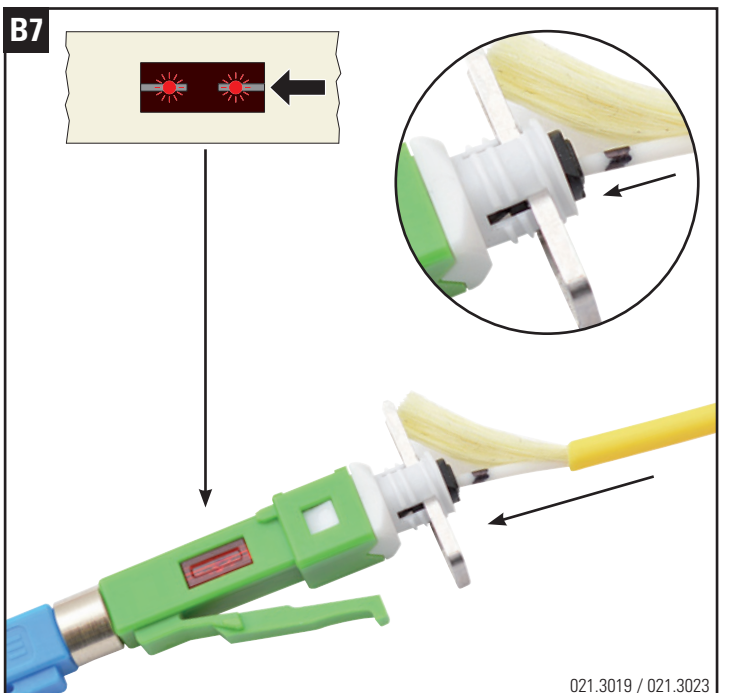
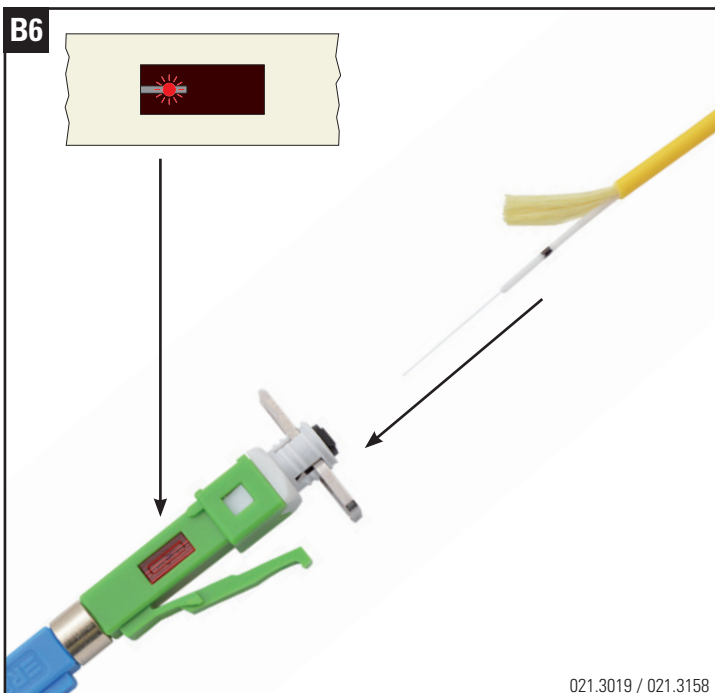
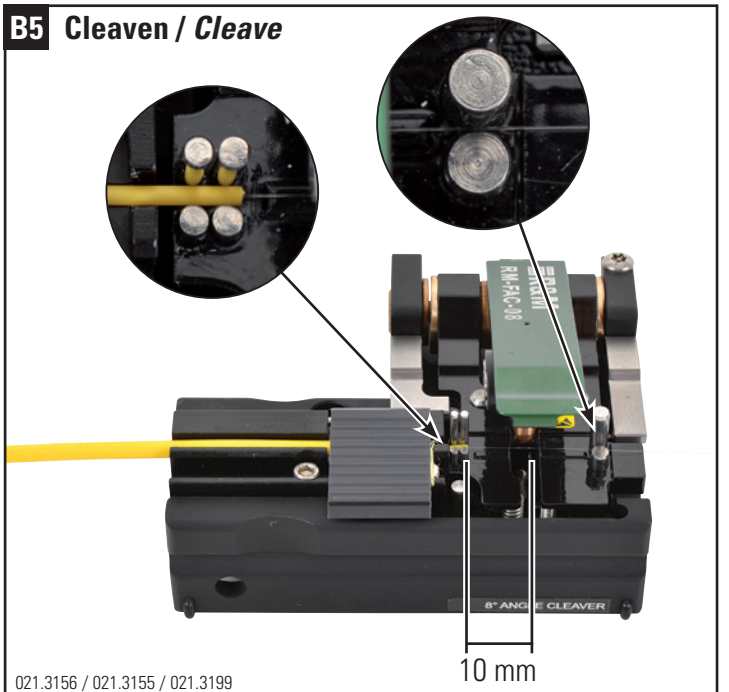
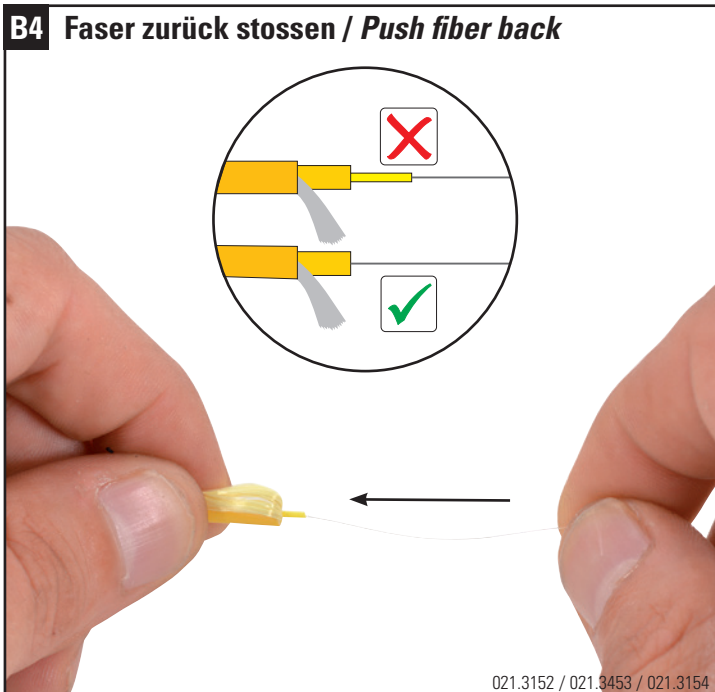
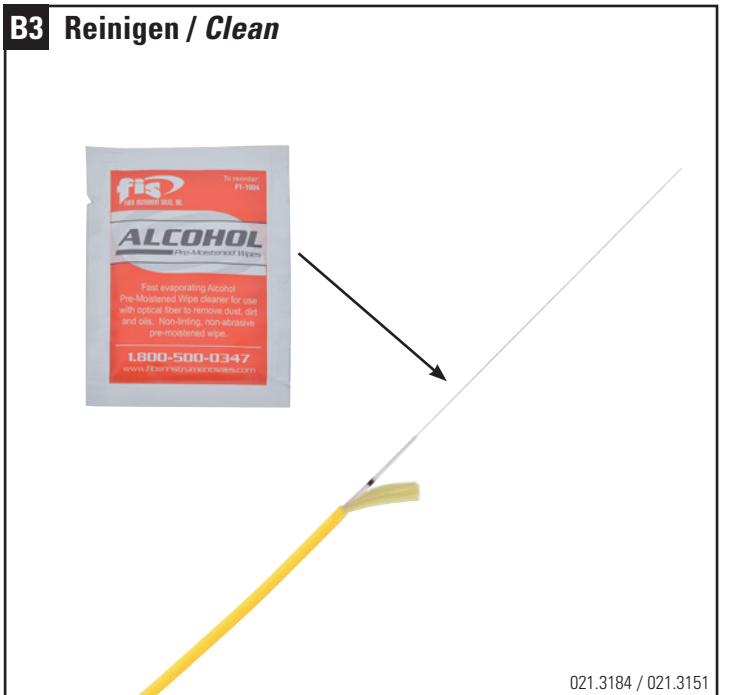

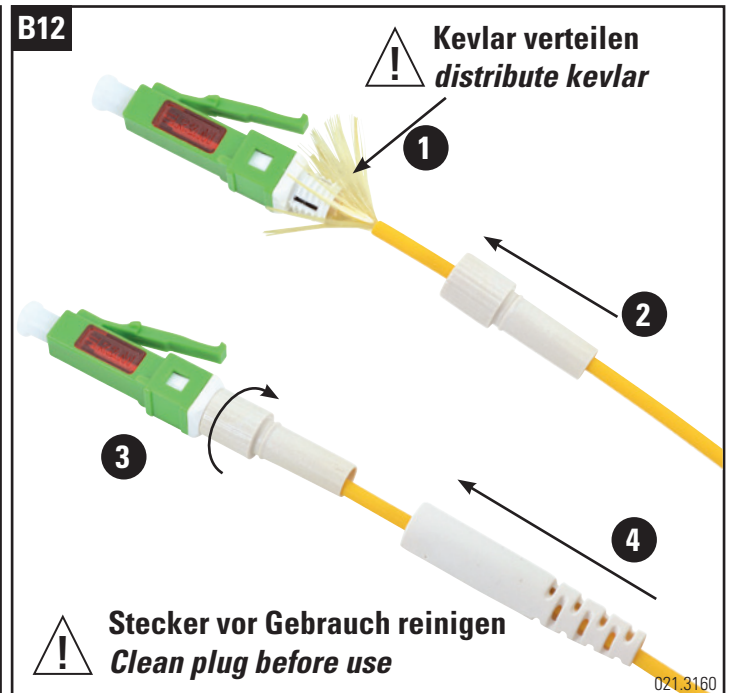
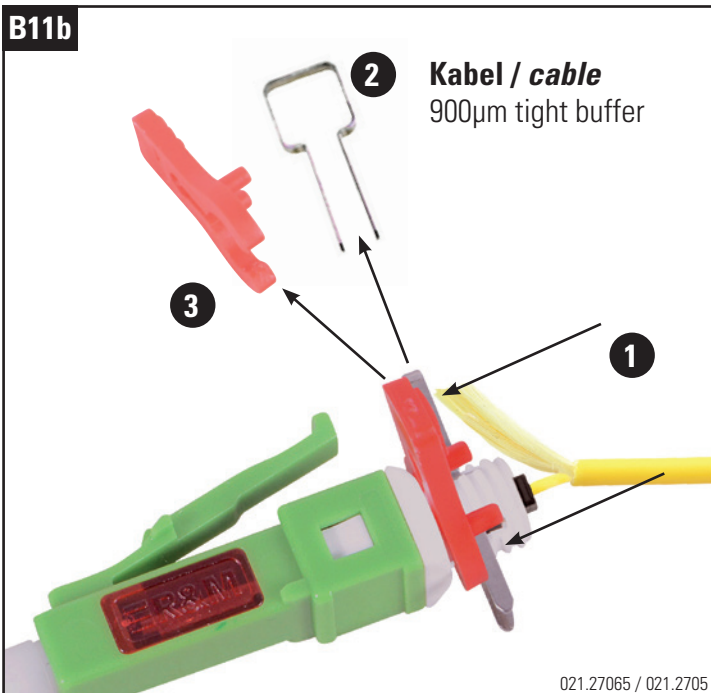
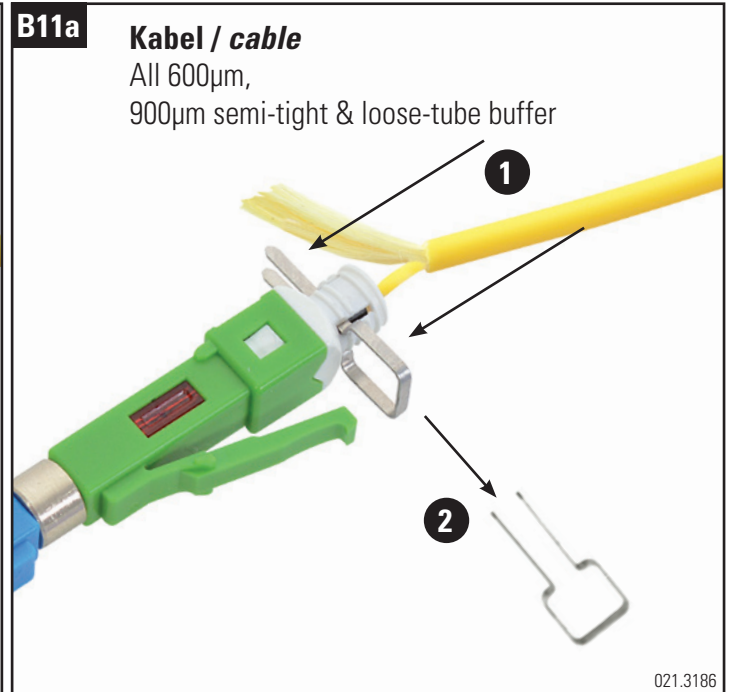
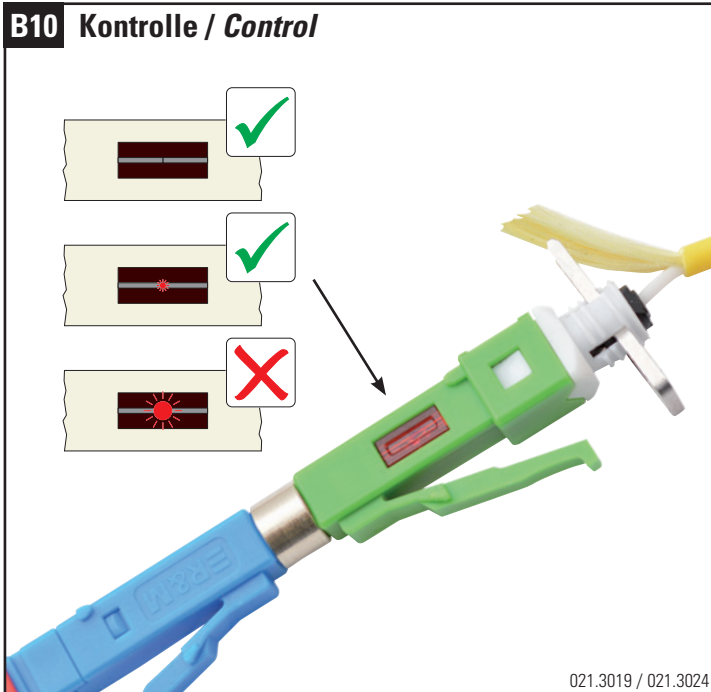
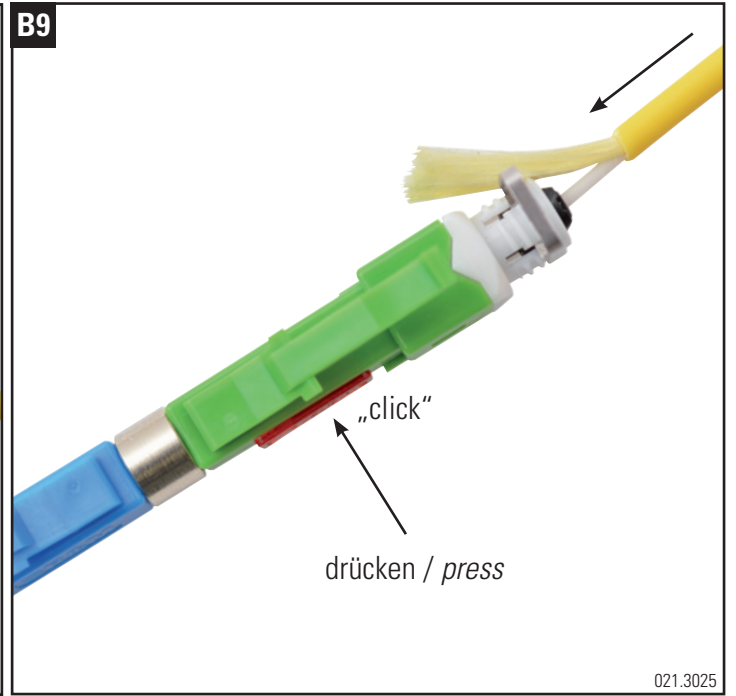
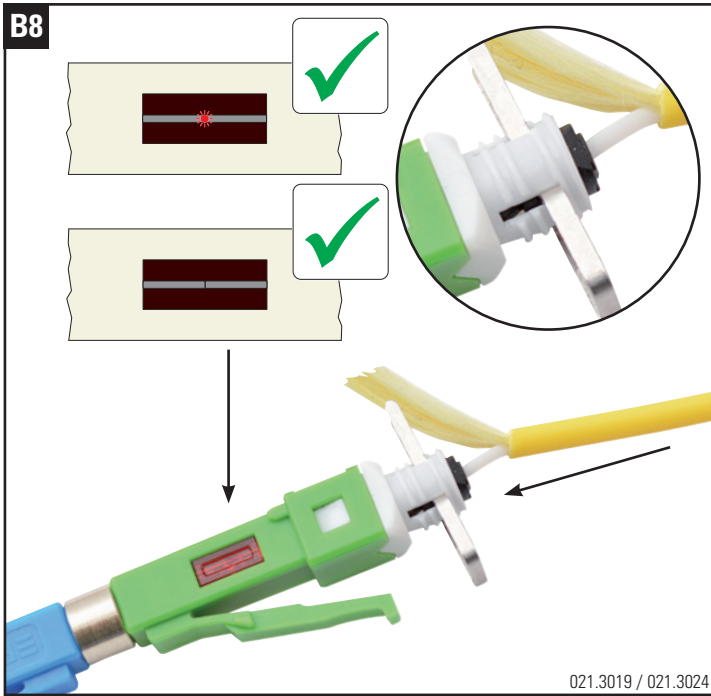

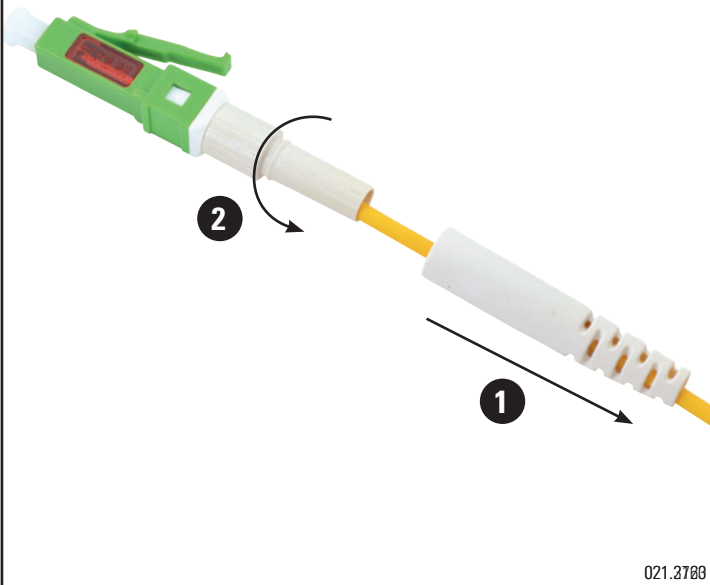
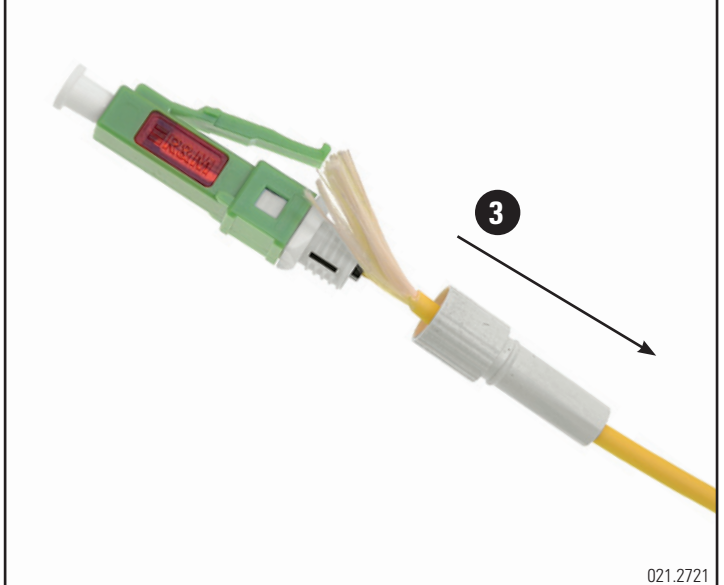
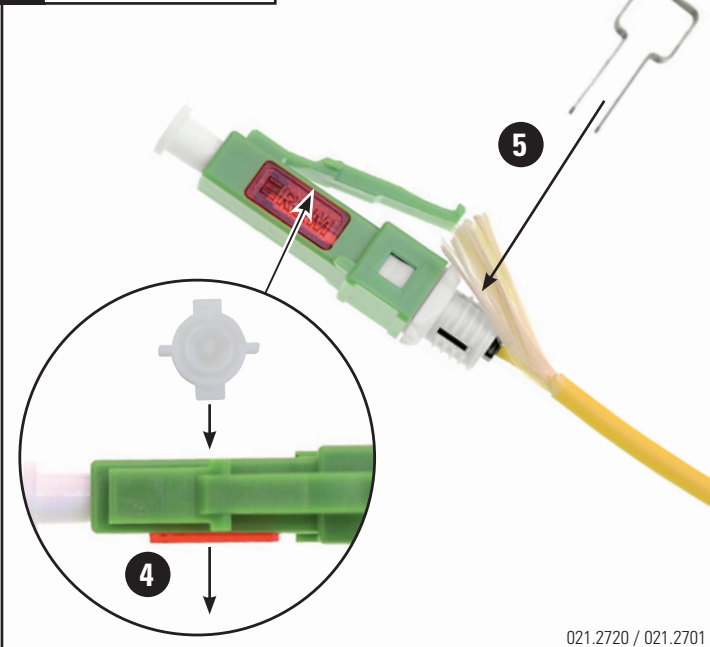
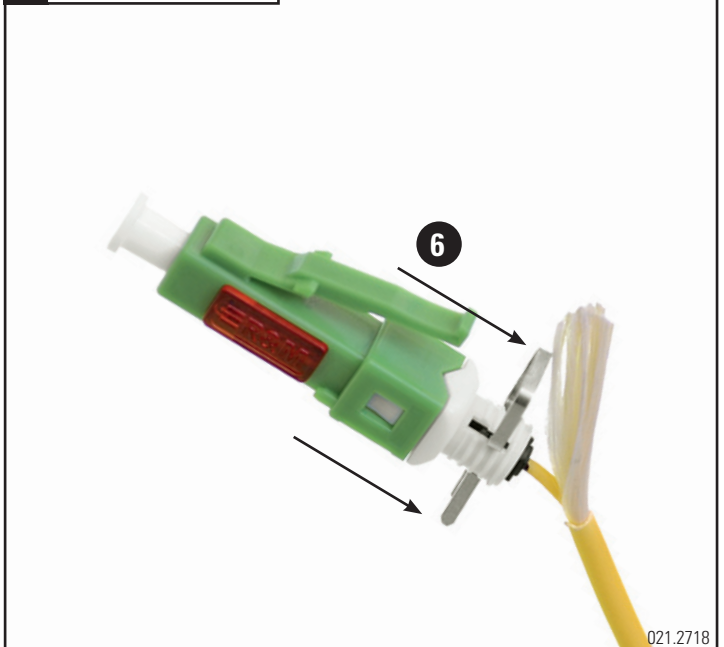
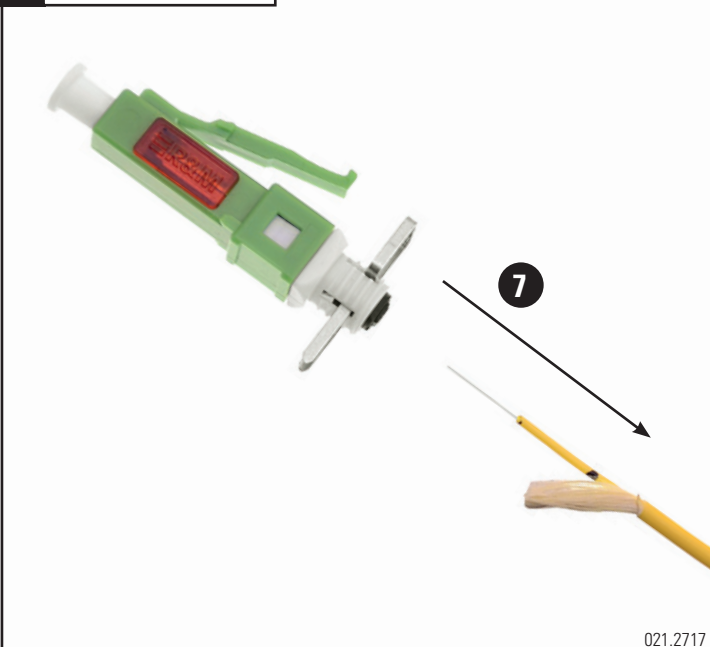
**C1 DEMONTAGE****C2 DEMONTAGE****C3 DEMONTAGE****C4 DEMONTAGE****C5 DEMONTAGE**

[www.rdm.com/pif\\_patch](http://www.rdm.com/pif_patch)

**Headquarters****Switzerland**

Reichle & De-Massari AG

Binzstrasse 32

CHE-8620 Wetzikon

Telephone HQ +41 (0)44 933 81 11

Telefax HQ +41 (0)44 930 49 41

E-Mail [hq@rdm.com](mailto:hq@rdm.com)

[www.rdm.com](http://www.rdm.com)

**R&M**