

Installationsanleitung PRIME-3/4HE-FBU
Installation guide PRIME-3/4U-FBU
Instructions de montage PRIME-3/4U-FBU

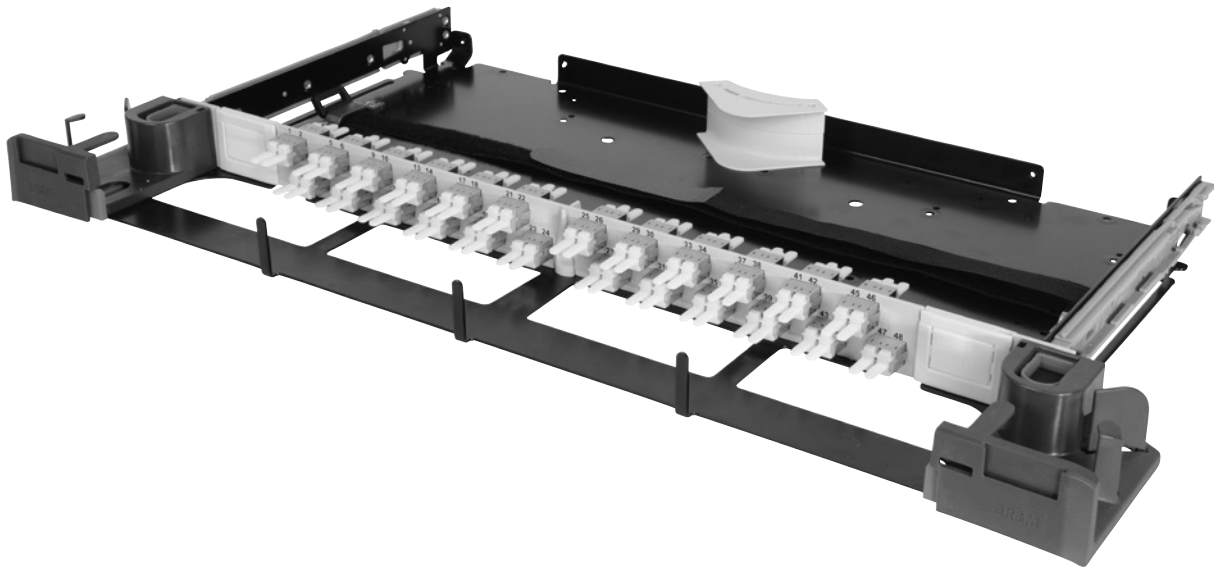

021.5236

A - Einsetzen / Mounting

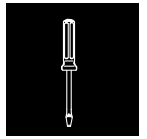
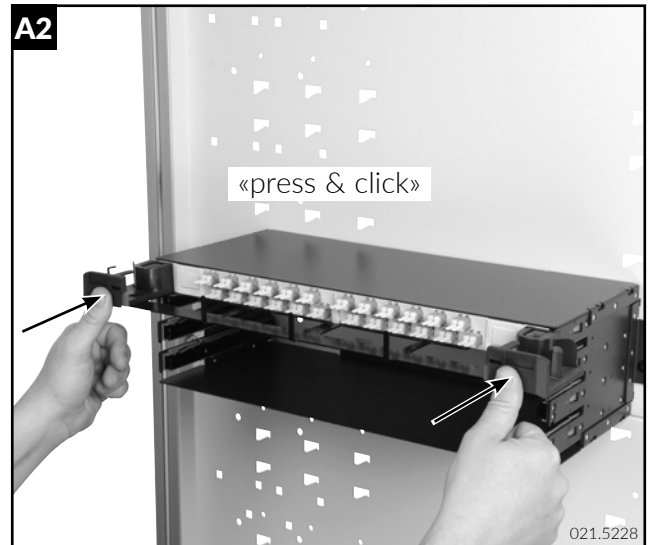
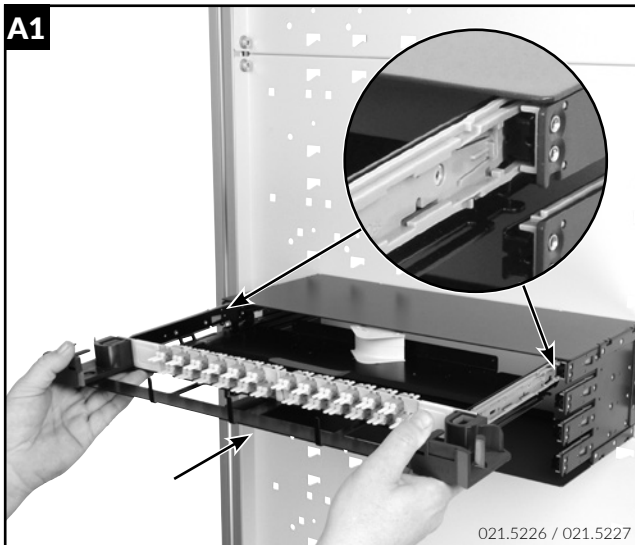

B - Öffnen / Opening

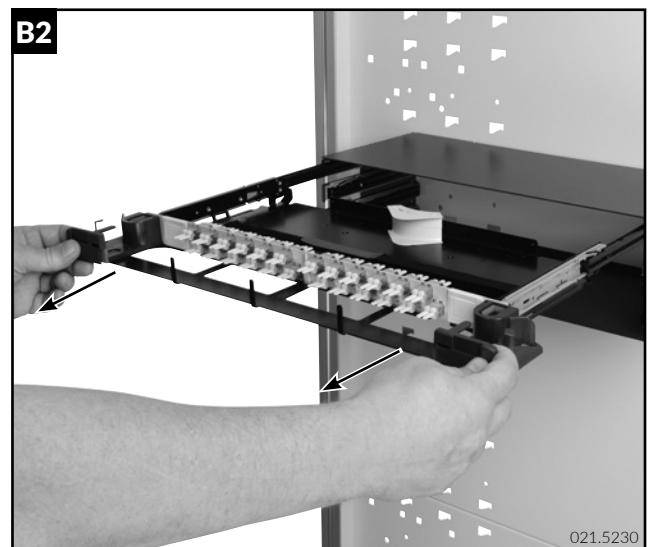
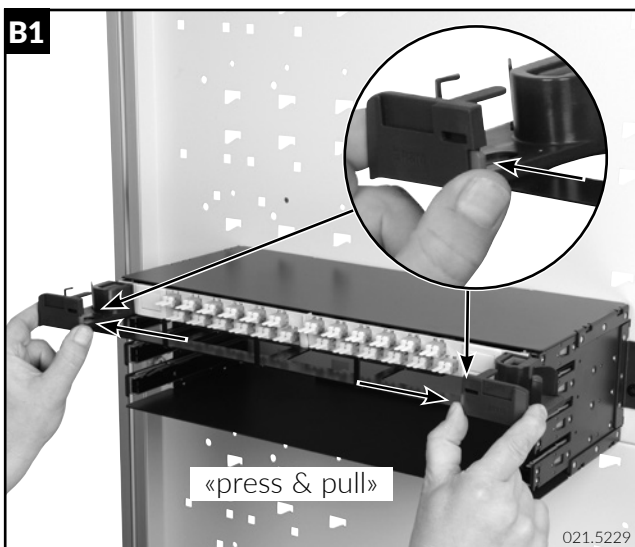

C - Ausbau / Removing

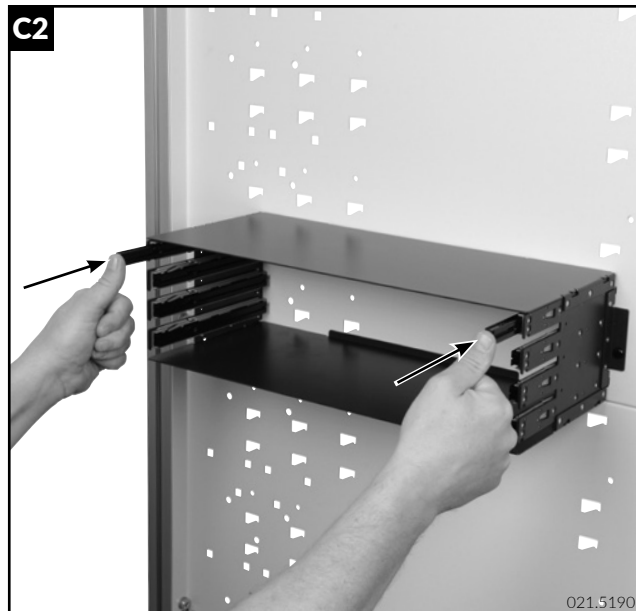
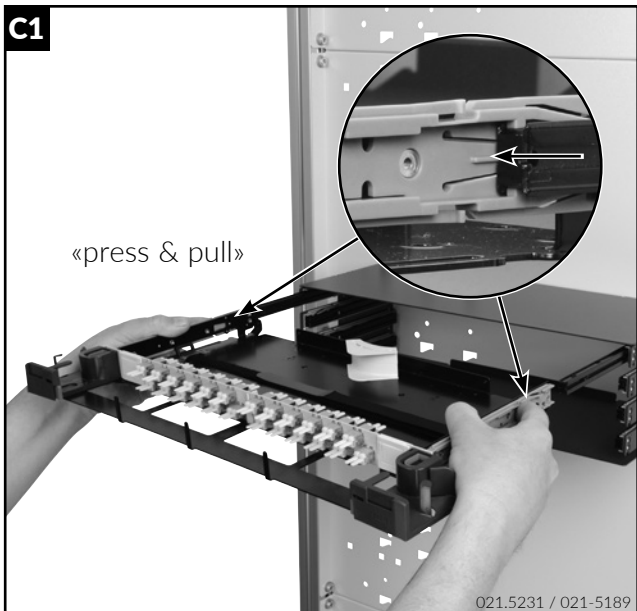

D - Kabelführung von vorne / Cable feeding from front side

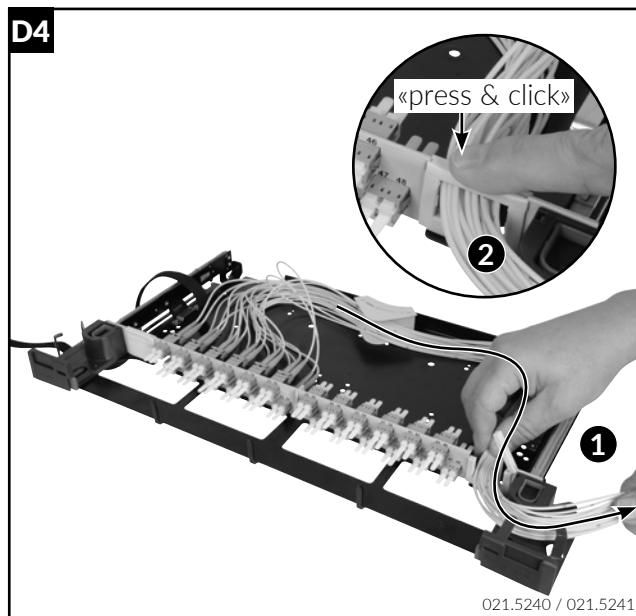
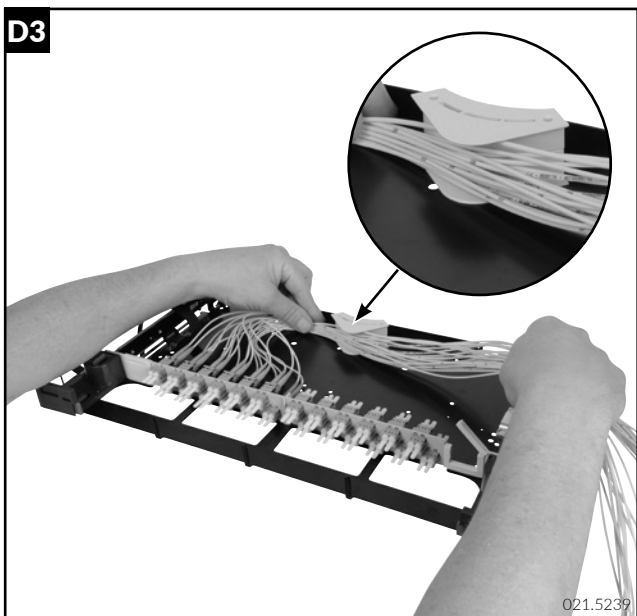
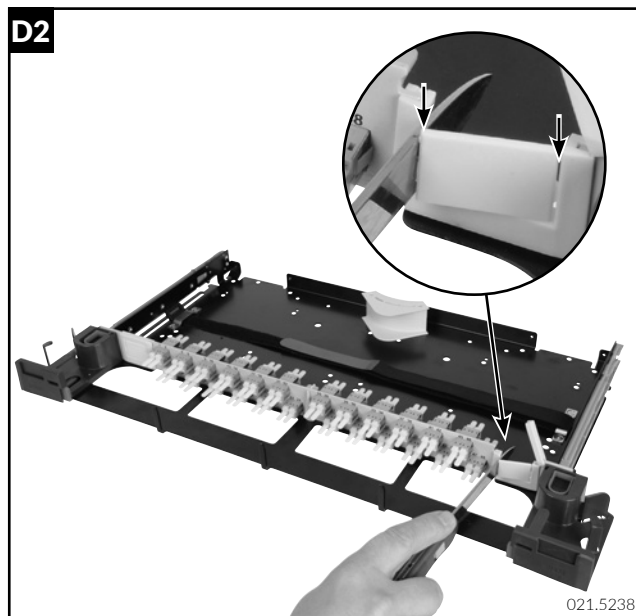
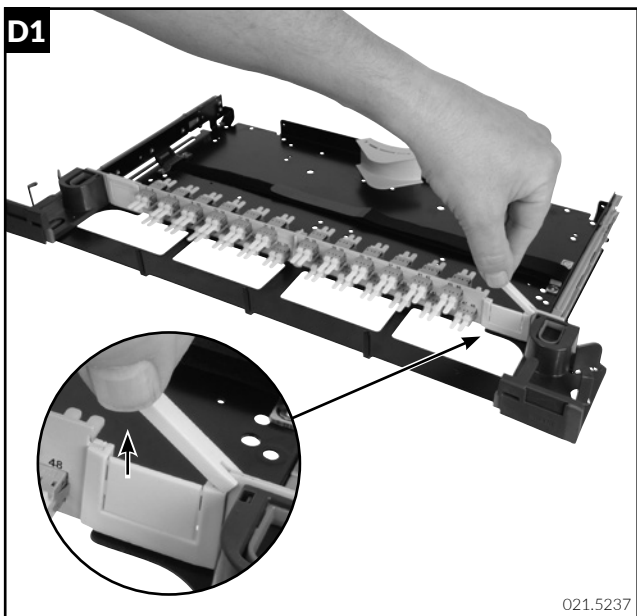

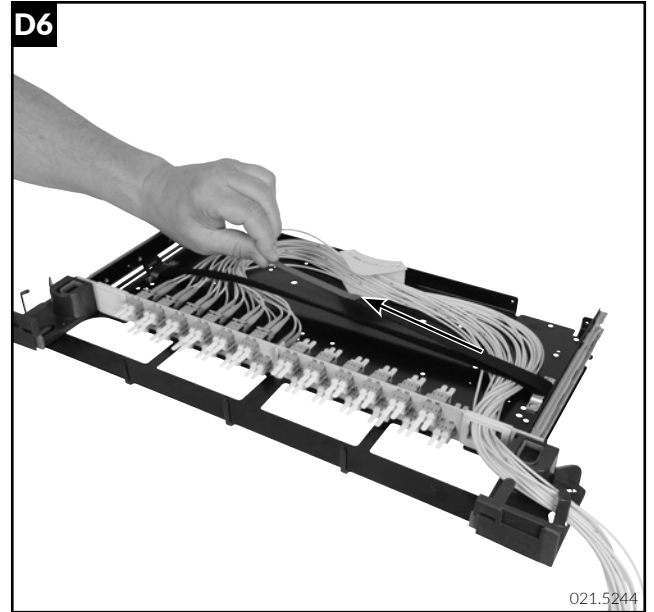
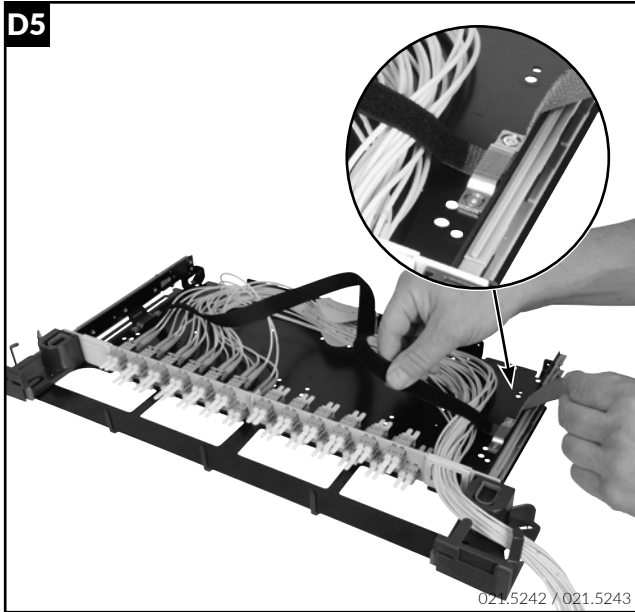

E - Kabelführung von hinten / Cable feeding from back side

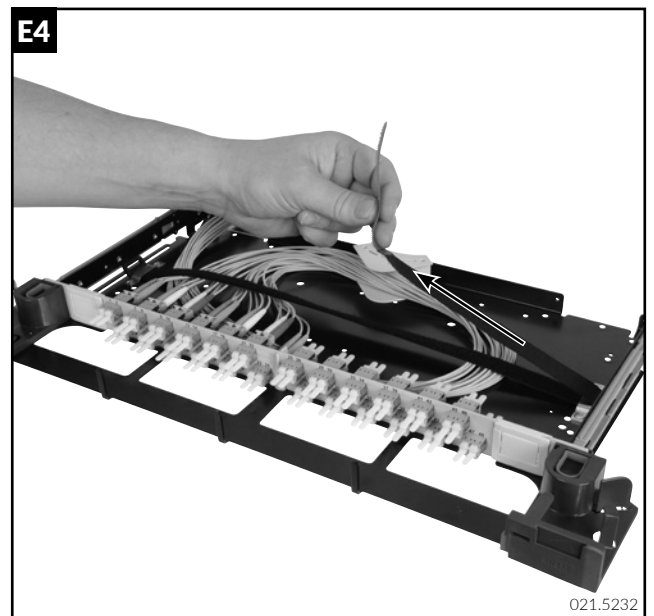
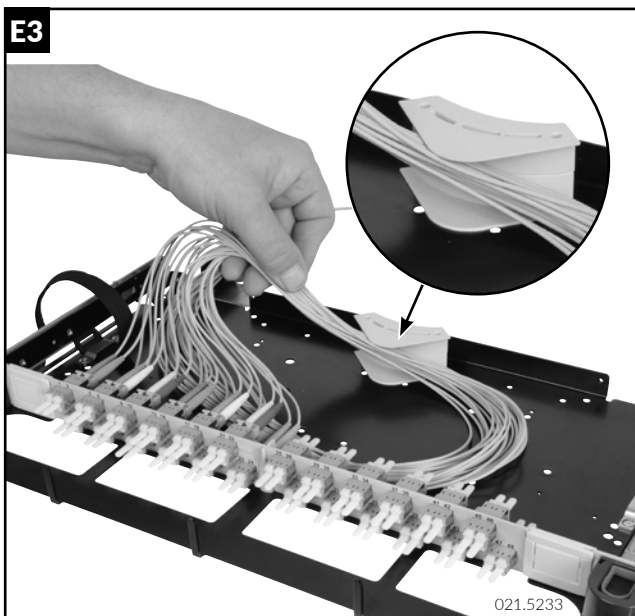
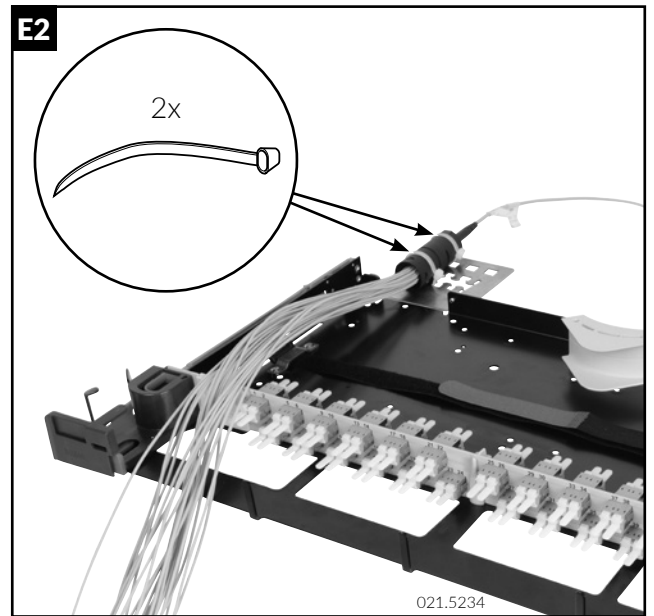
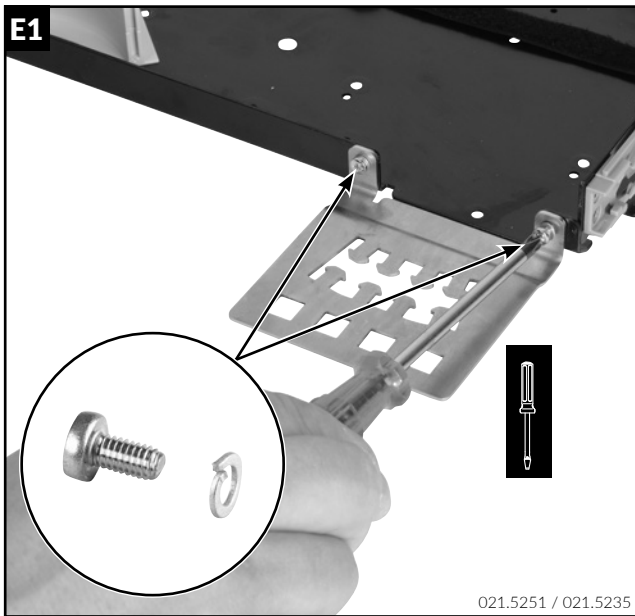

F - Bedienung Frontkabelmanager / Handling front cable manager

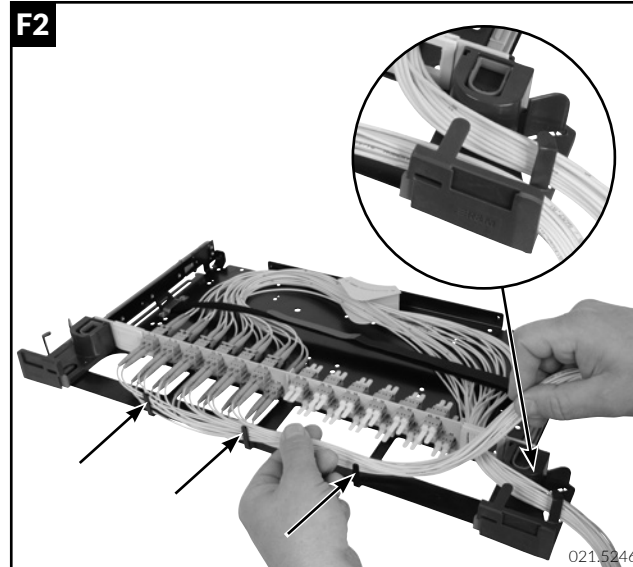
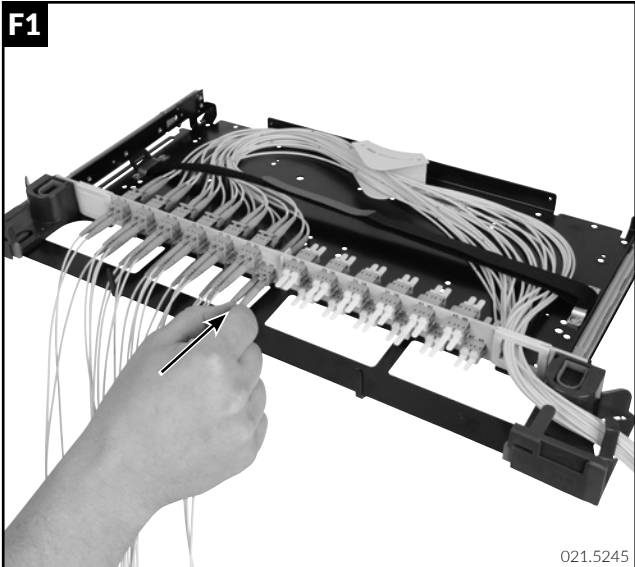

G - Kabel nach hinten (OPTIONAL) / Cable to the back (OPTIONAL)

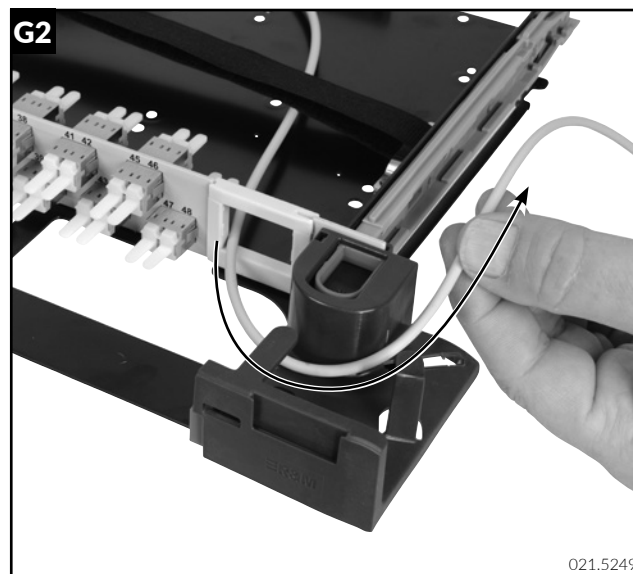
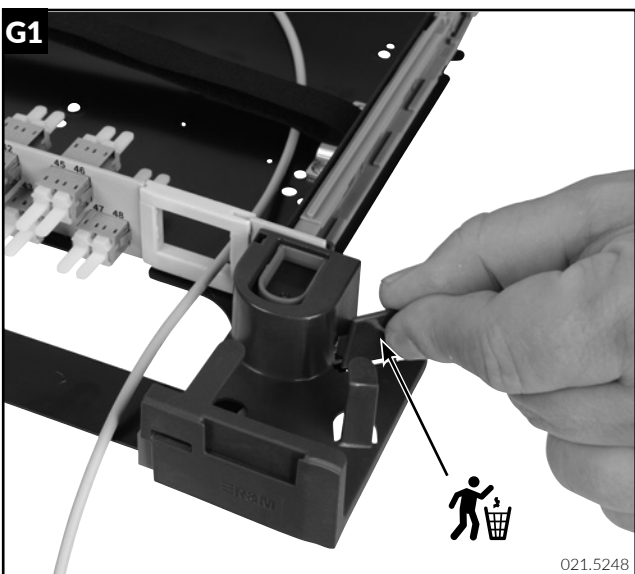

H - Beschriftung / Labeling

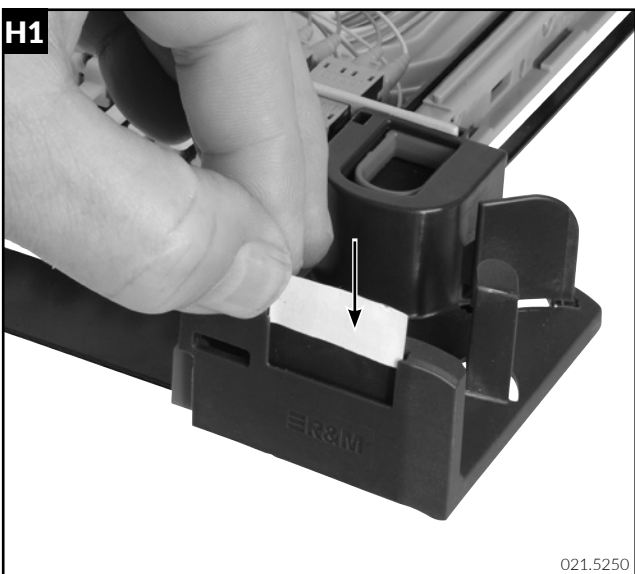

Headquarters

Switzerland

Reichle & De-Massari AG
Binzstrasse 32
CHE-8620 Wetzikon
Telephone HQ +41 (0)44 933 81 11
Telefax HQ +41 (0)44 930 49 41
E-Mail hq@rdm.com

www.rdm.com

R&M

Please note:

This guide shows the best practices for installation **ONLY**. R&M expressly disclaims all liability for any damage to material, equipment, and for any injury or death. Legal health and safety regulations should have priority over best practices as shown in this guide. R&M does not guarantee this guide to be free of errors. Products included may vary from products shown. Please exercise caution.