

Installationsanleitung PRIME-3/4U-STU/SSU
Installation guide PRIME-3/4U-STU/SSU
Instructions de montage PRIME-3/4U-STU/SSU

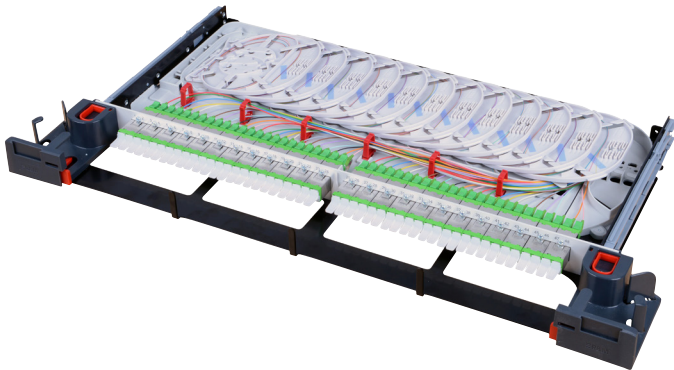

PRIME-STU



PRIME-SSU

021.6059 / 021.6060

A - Montage im PRIME-Gestell / Mounting in PRIME-cabinet

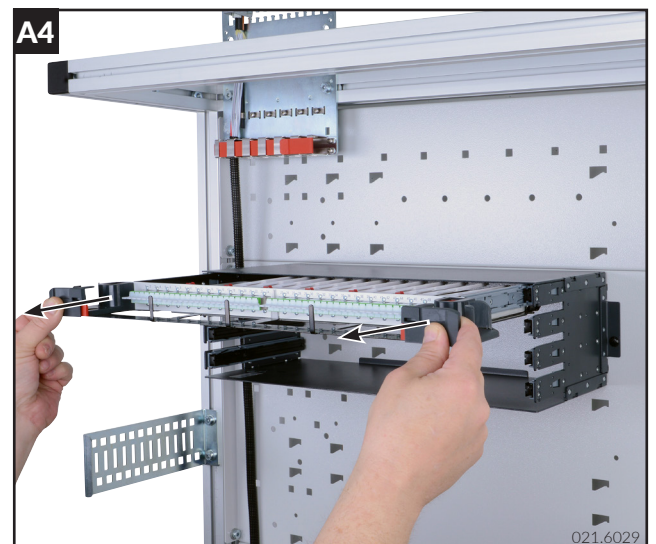
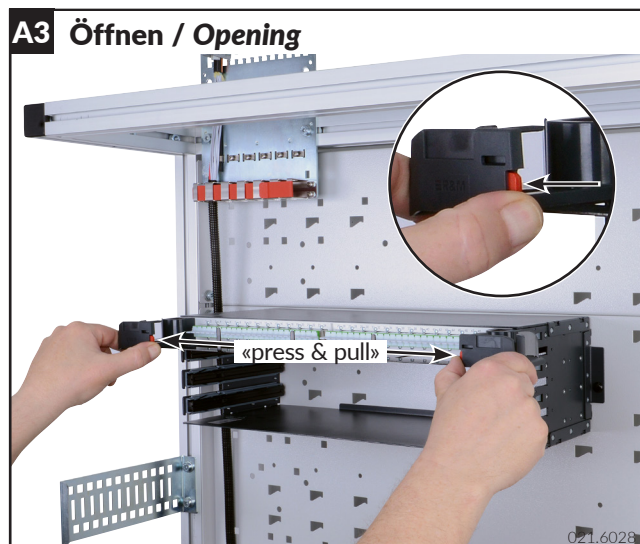
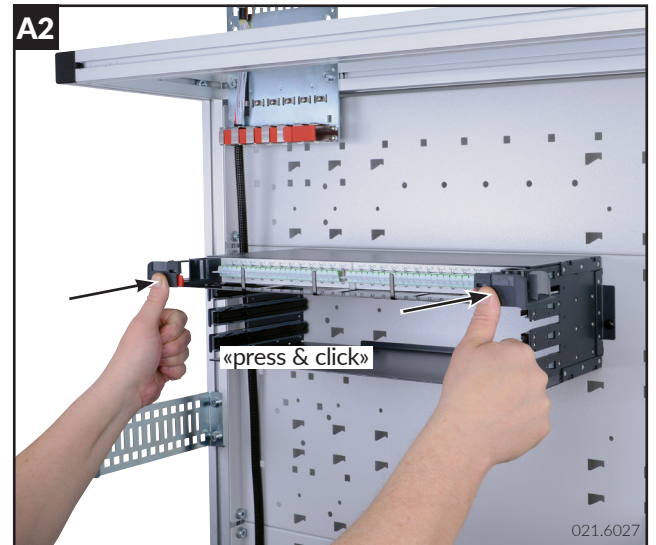
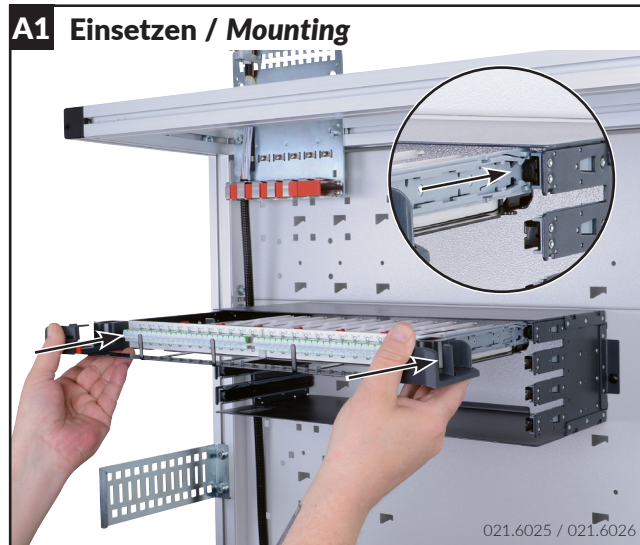

B - Kabelzuführung von der Seite / Cable feeding from the side

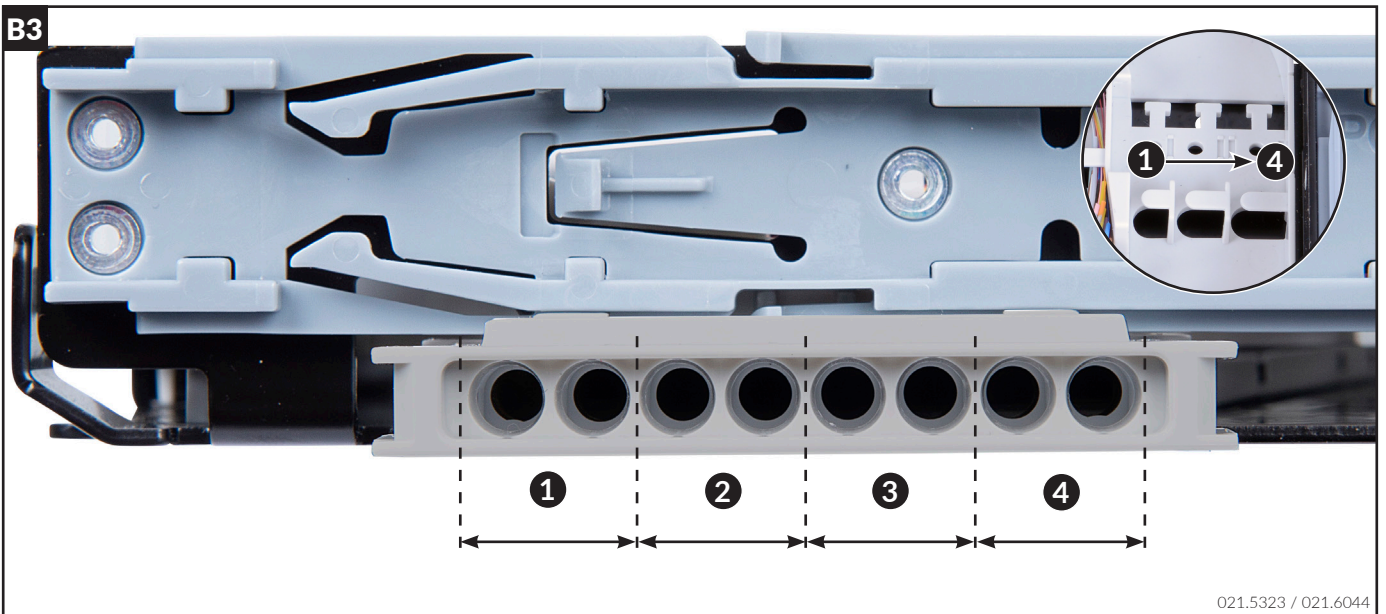
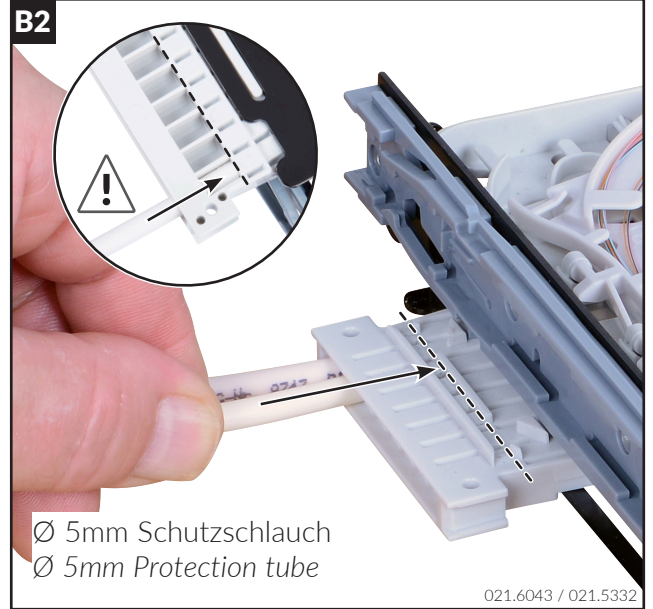
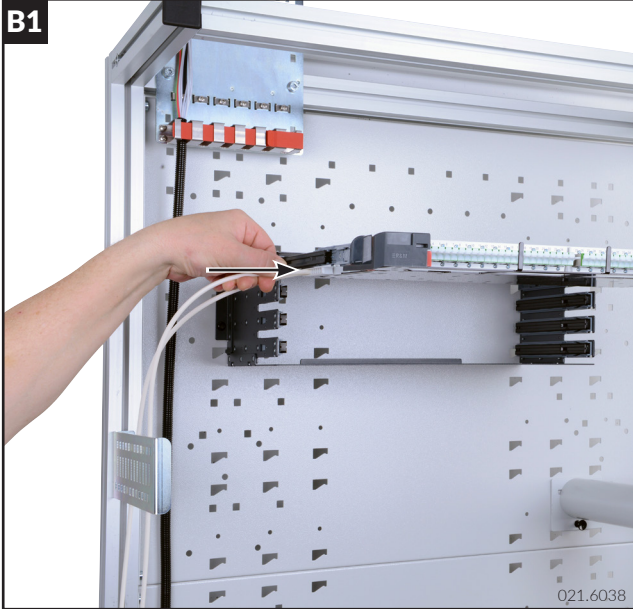

C - Kabelaufteiler / Cable distribution

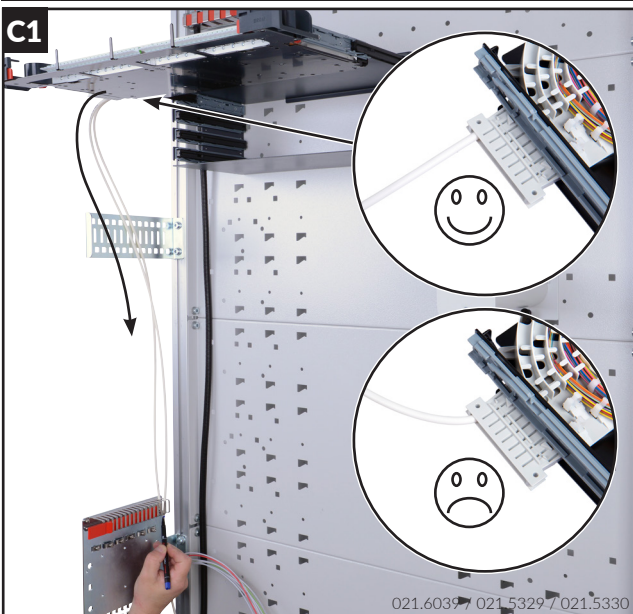

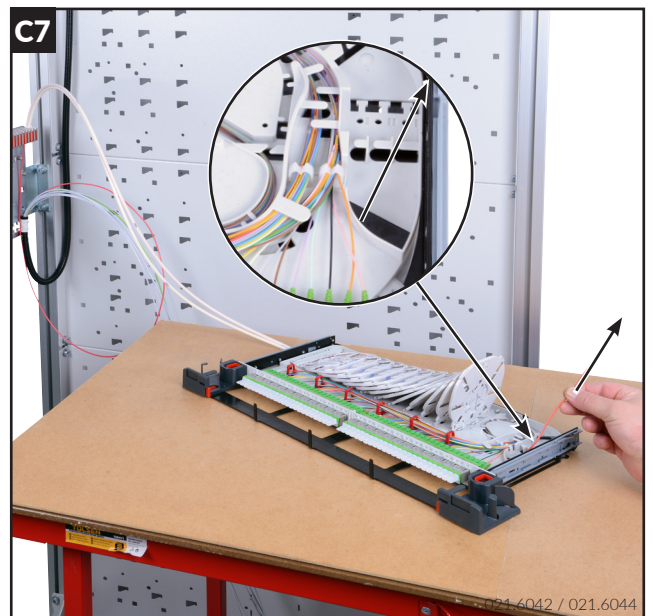
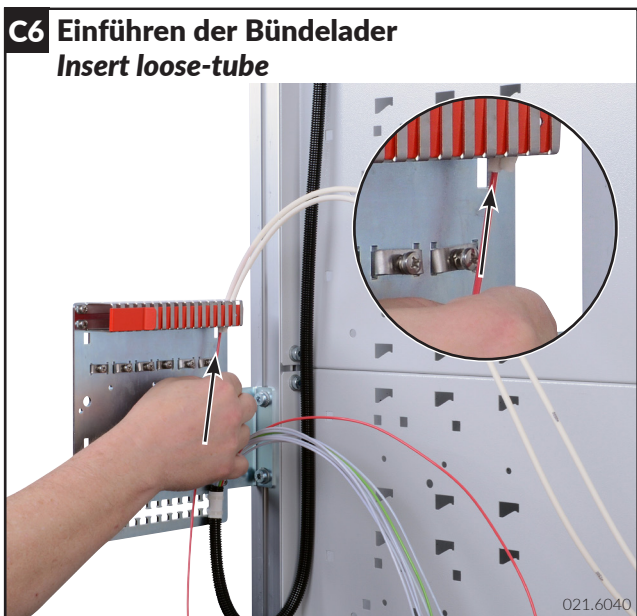
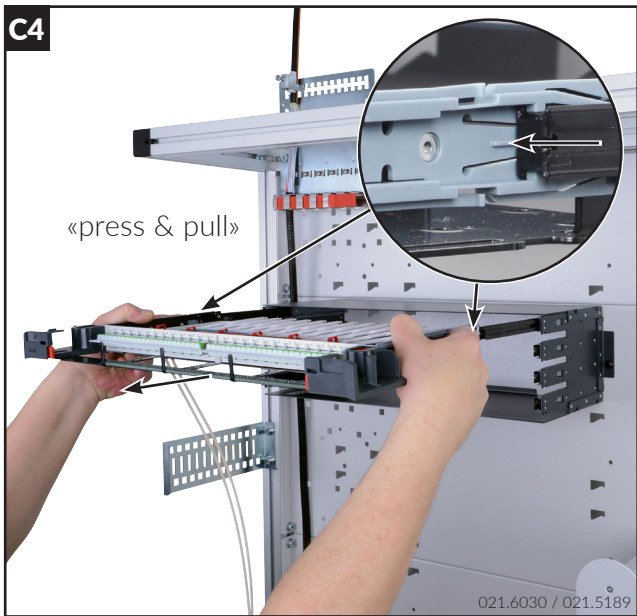
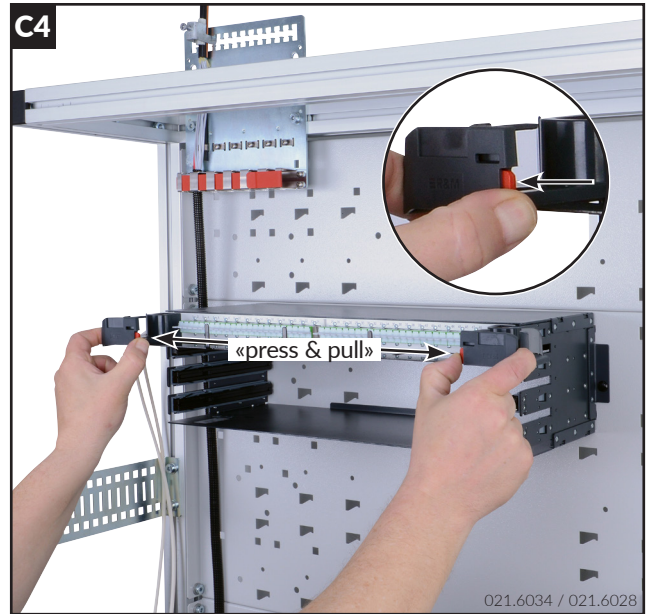

D - Montage im 19" Gestell mit frontseitiger Befestigung / Mounting in 19" cabinet with front rail fixation

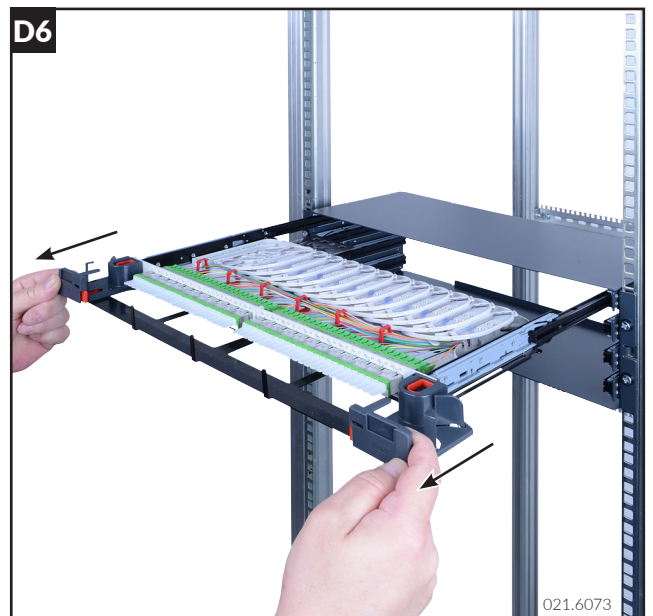
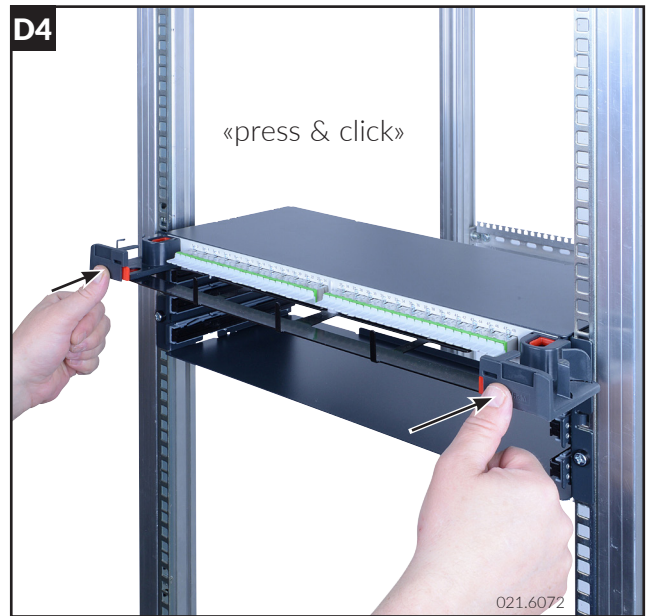
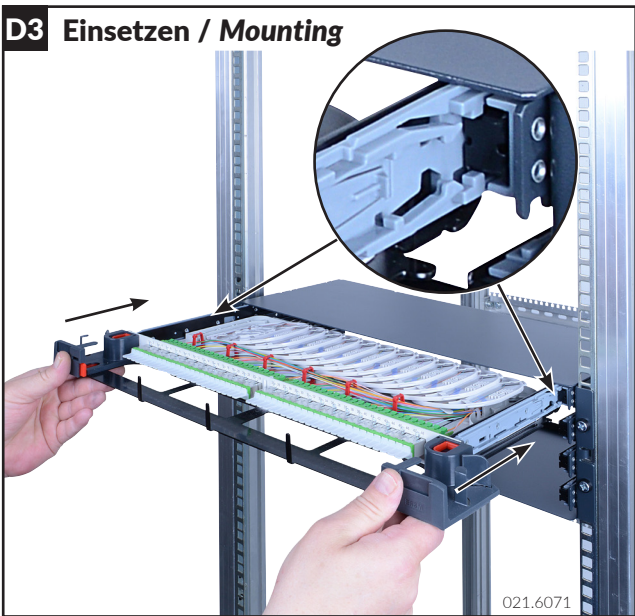
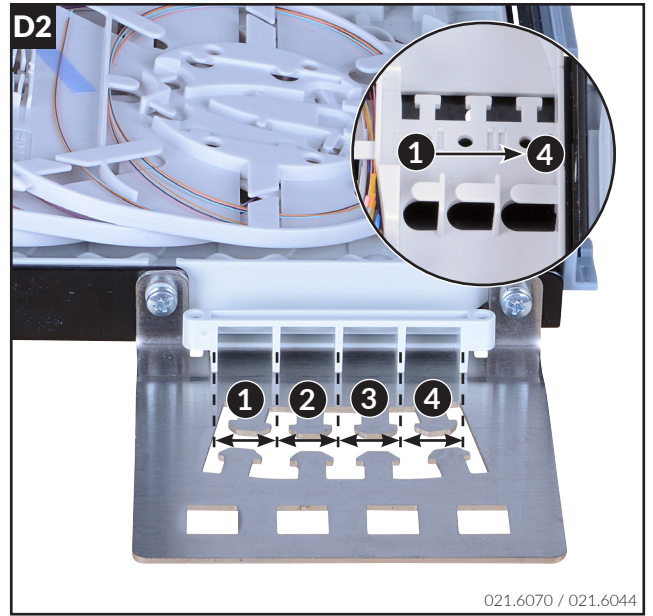
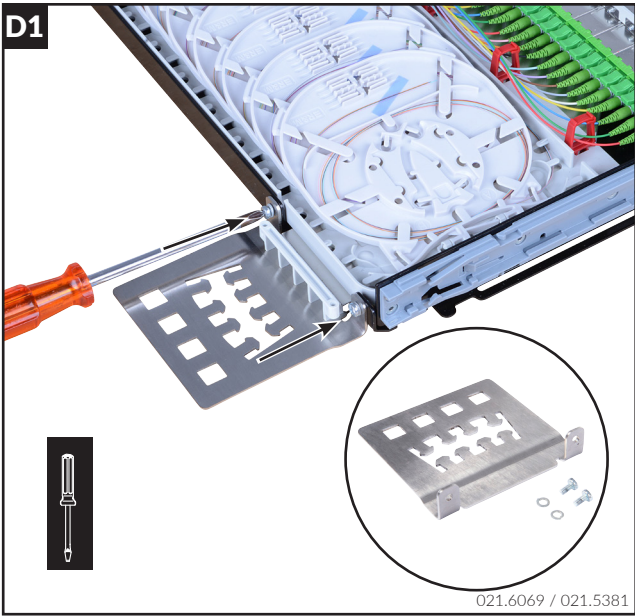

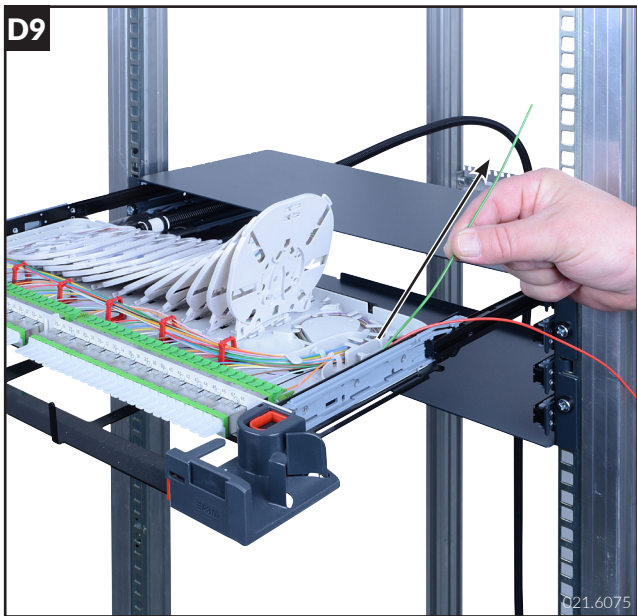
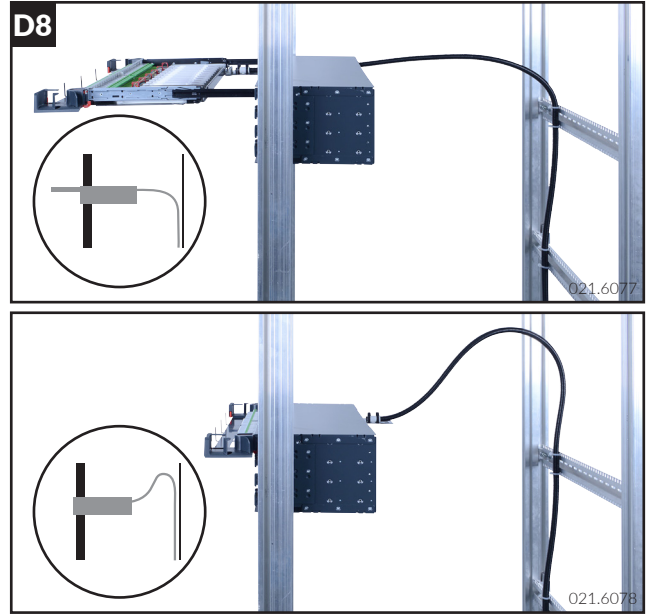
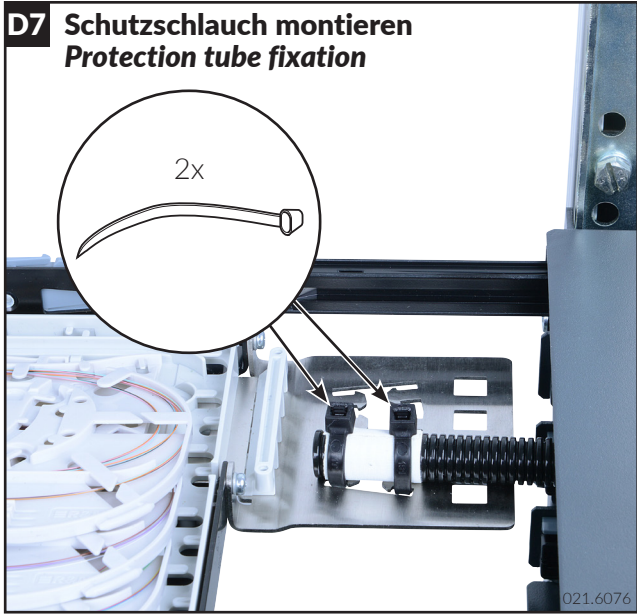

E - Bündelader und Fasereinführung / Loose-tube and fiber insertion

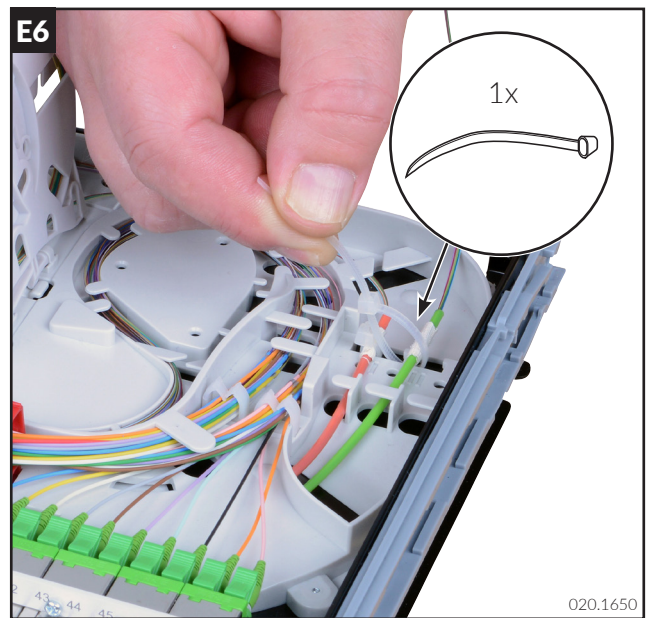
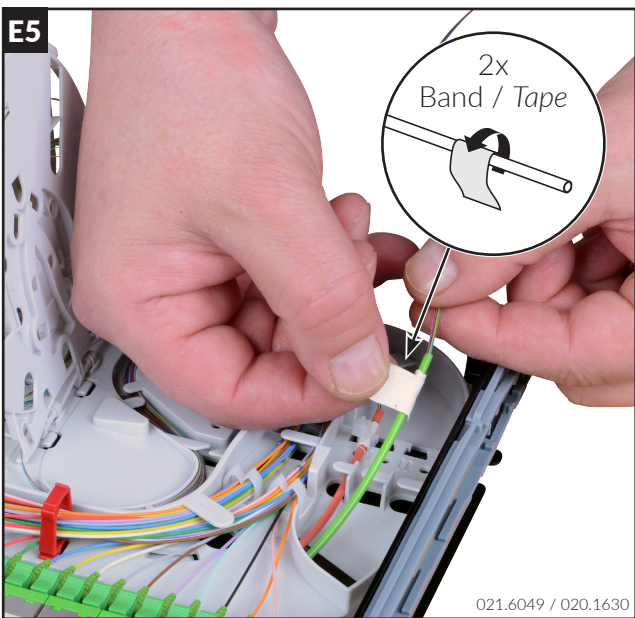
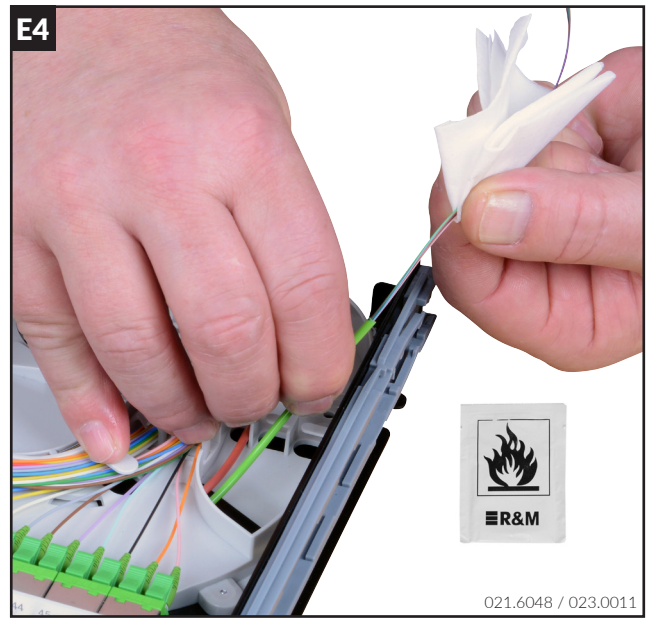
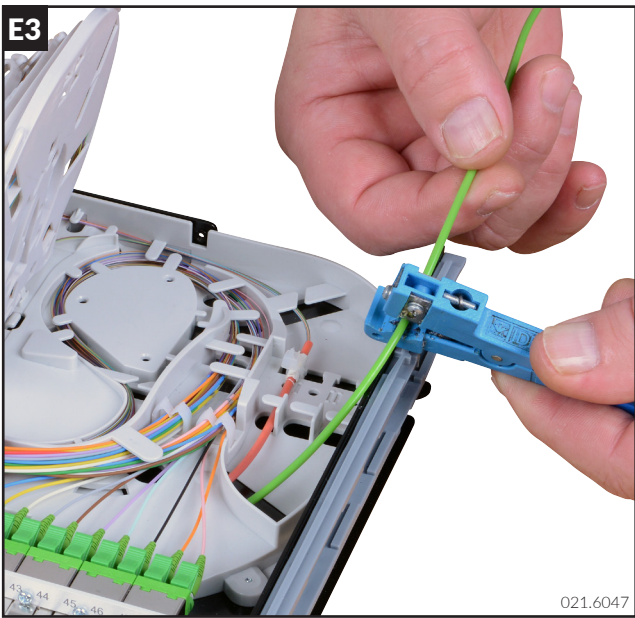
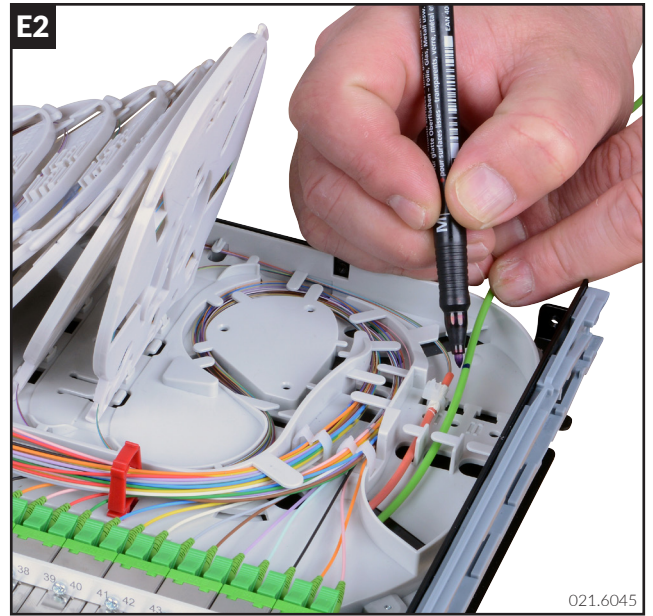
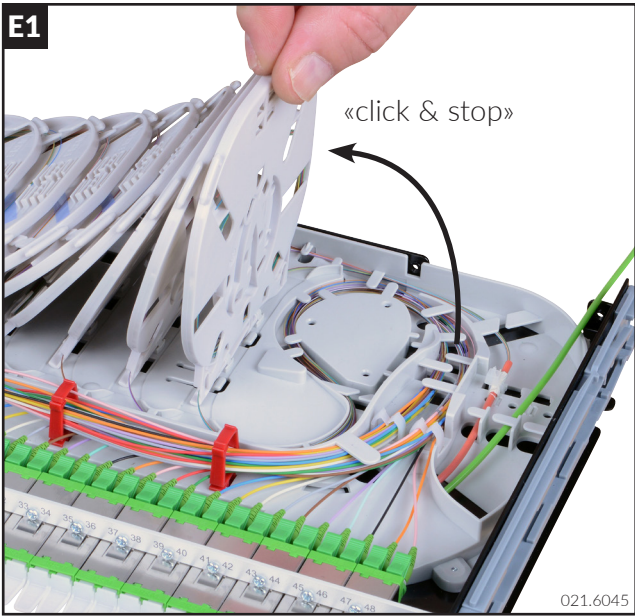

F - Clip Befestigung (optional) / Clip fixation (optional)

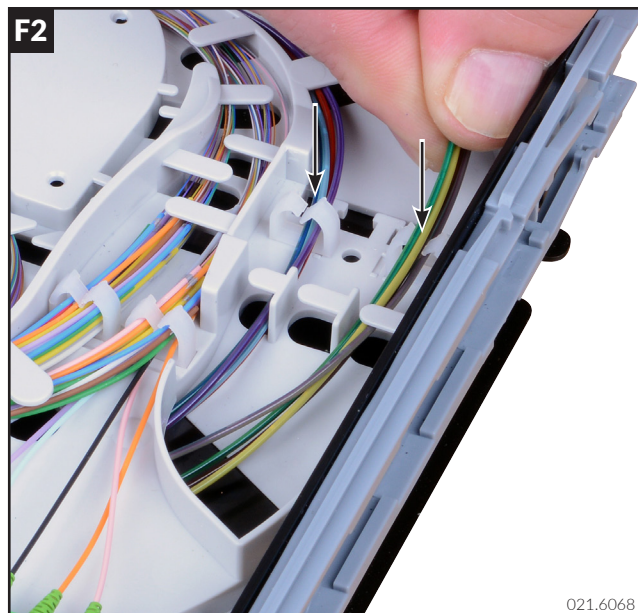
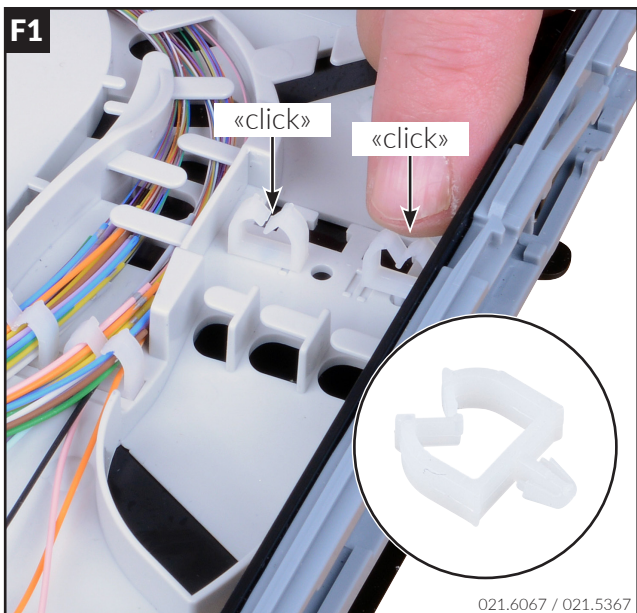

G - Faser spleissen / Fiber splice

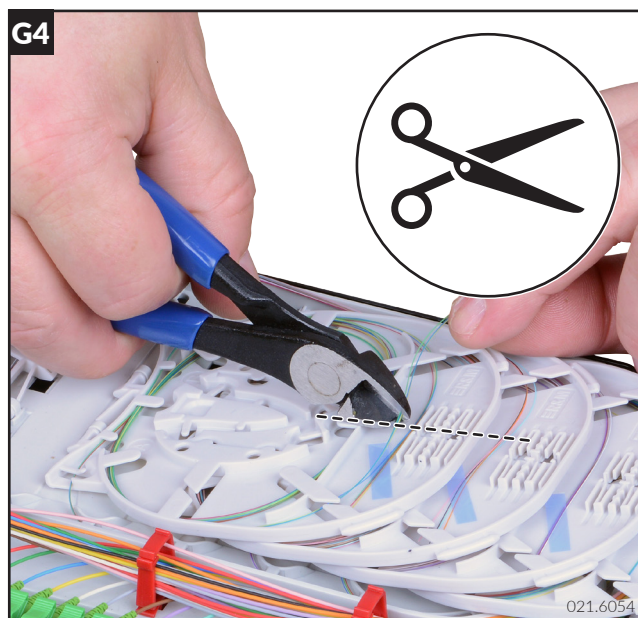
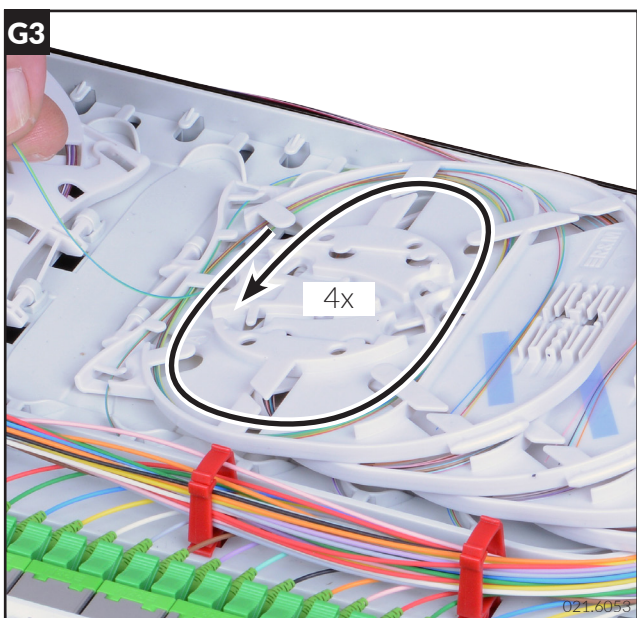
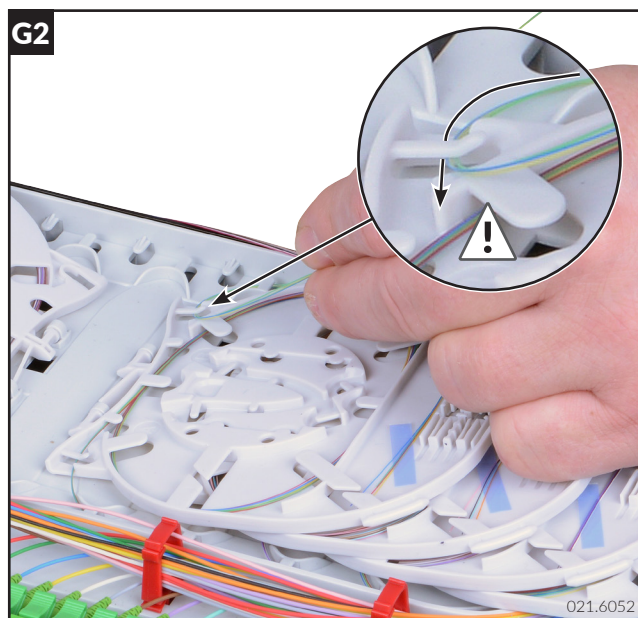
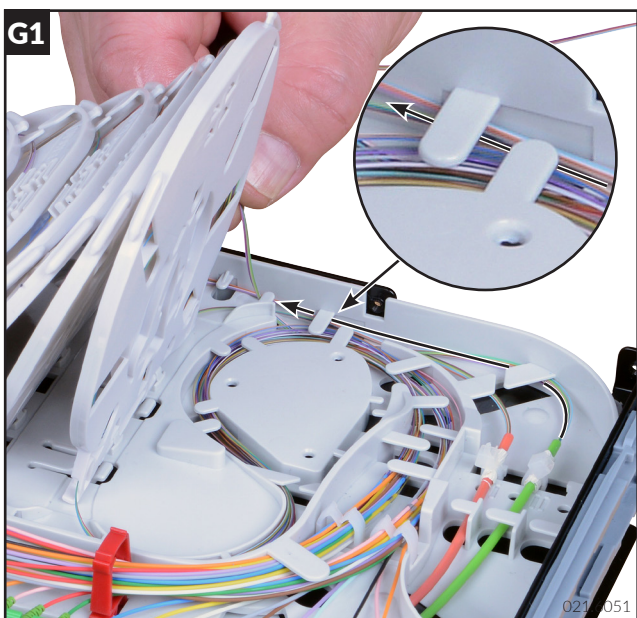

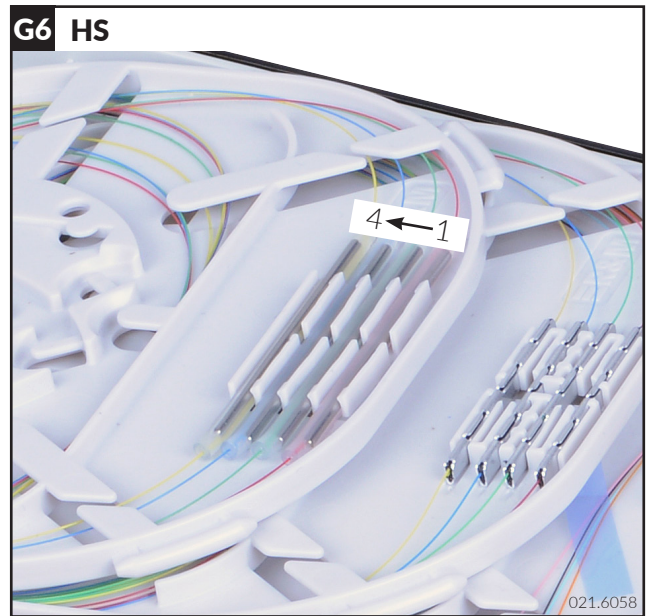
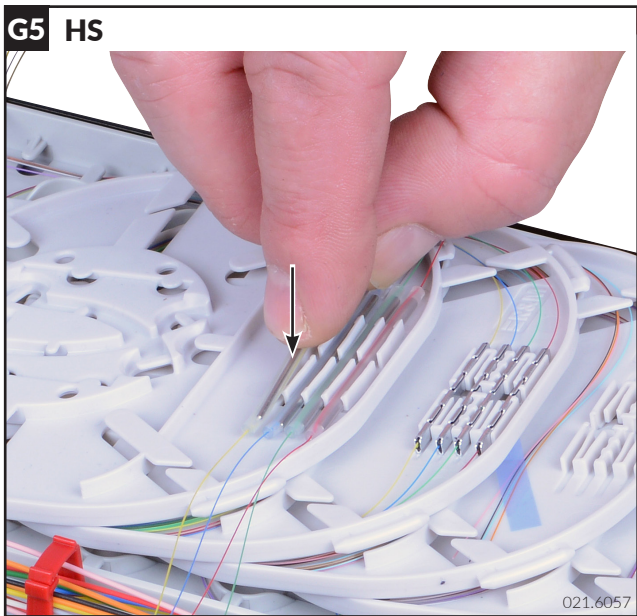
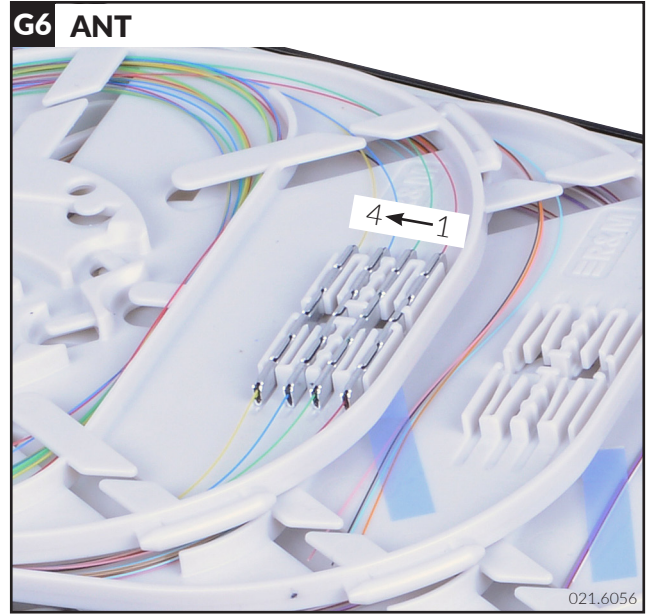
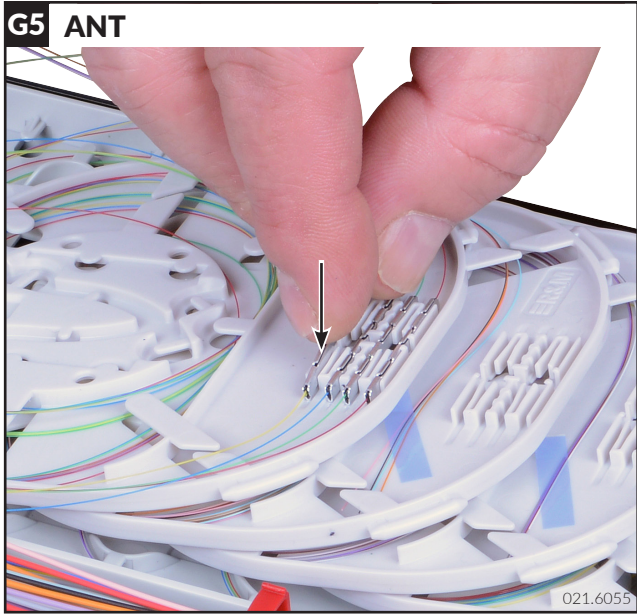

H - Spleisskassetten / Splice tray

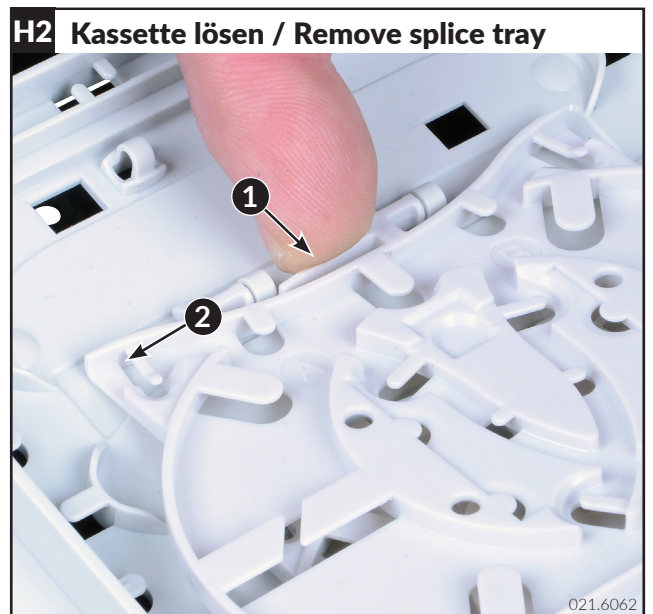
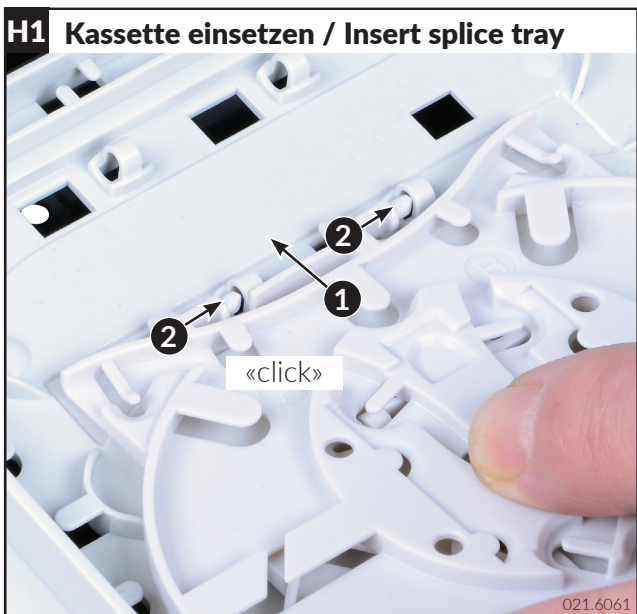

H3 Richtungswechsel in der Kassette /
Change of direction in the cassette



021.6063

H4 Beschriftung / Labeling



021.6064

I - Fasereinlage / Fiber inlay

I1 Faserführung A und B (Spleiss/Spleiss) /
Fiber routing A and B (Splice/Splice)

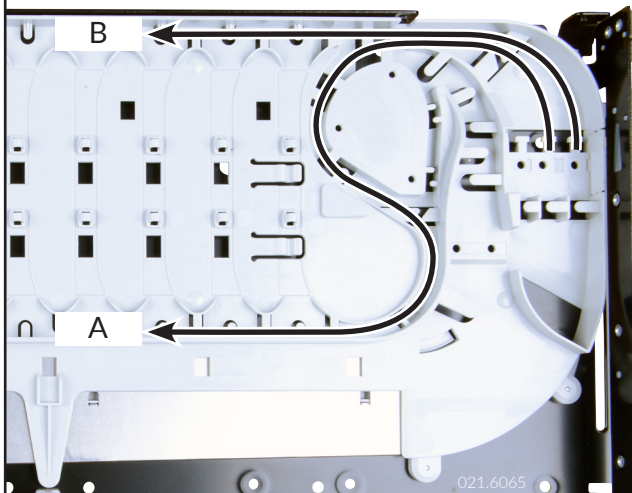

021.6065

I2 Richtungswechsel im der Fasereinlage /
Change of direction in the fiber inlay

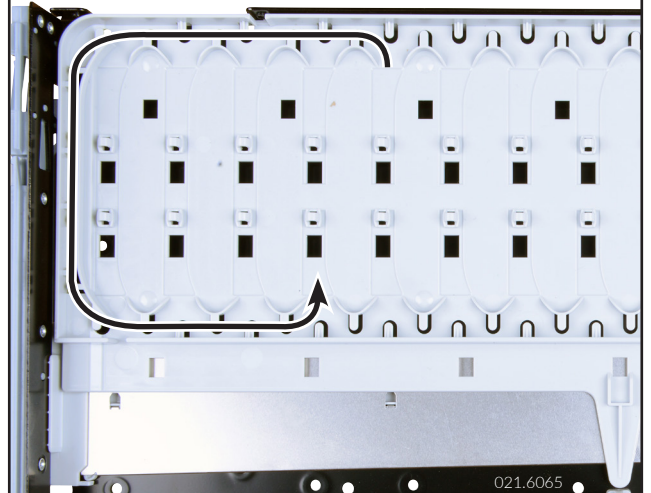

021.6065

I3 Fasereingang von oben /
Fiber in from above

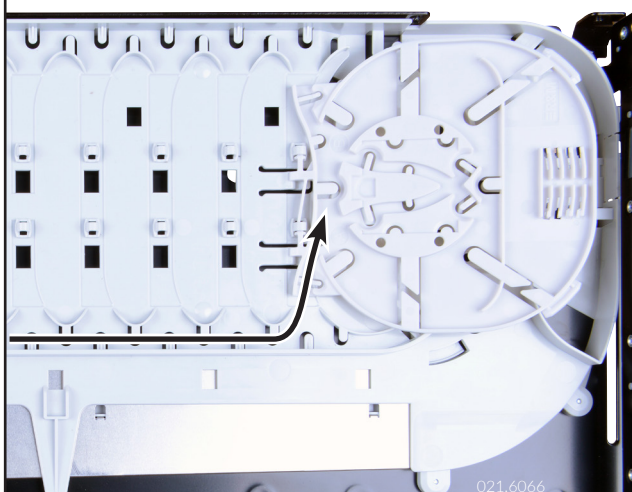

021.6066

I4 Richtungswechsel im Auskreuzbereich /
Change of direction in the crossover area

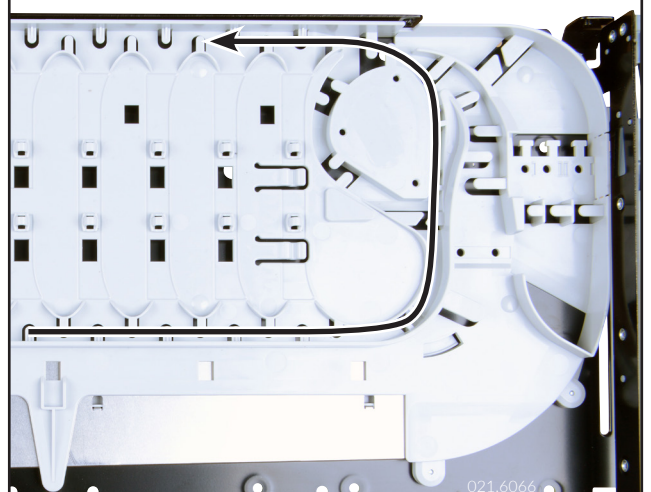

021.6066

J – Splitter Befestigungspunkte / Splitter mounting points

J1 *Optionale Position für Splitter 250µm. Max. 1(2) x 8*
Optional position for splitter 250µm. Max. 1(2) x 8



021.6063

J2 *Optionale Position für Splitter 900µm. Max. 1(2) x 32*
Optional position for splitter 900µm. Max. 1(2) x 32

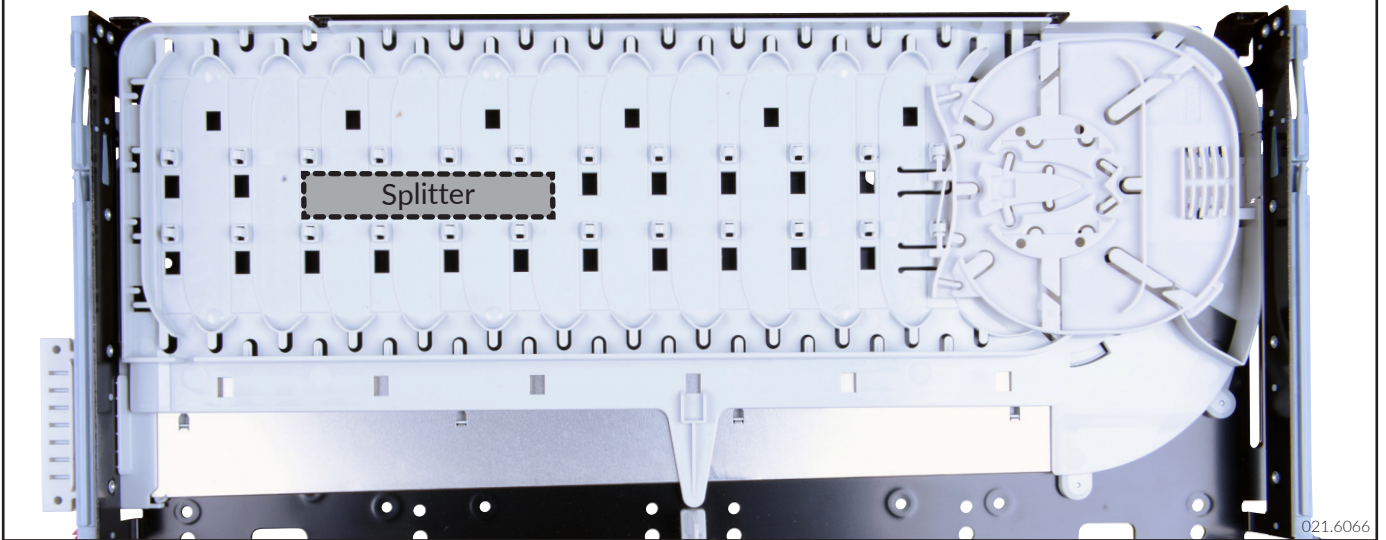

021.6066

K - Einsetzen / Mounting

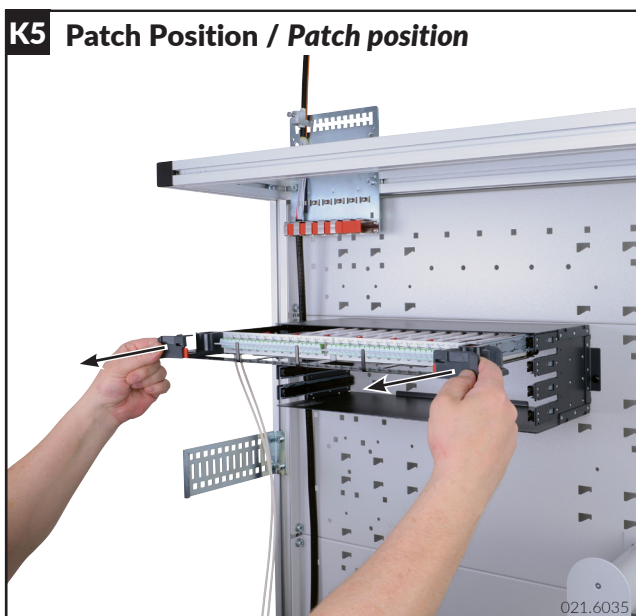
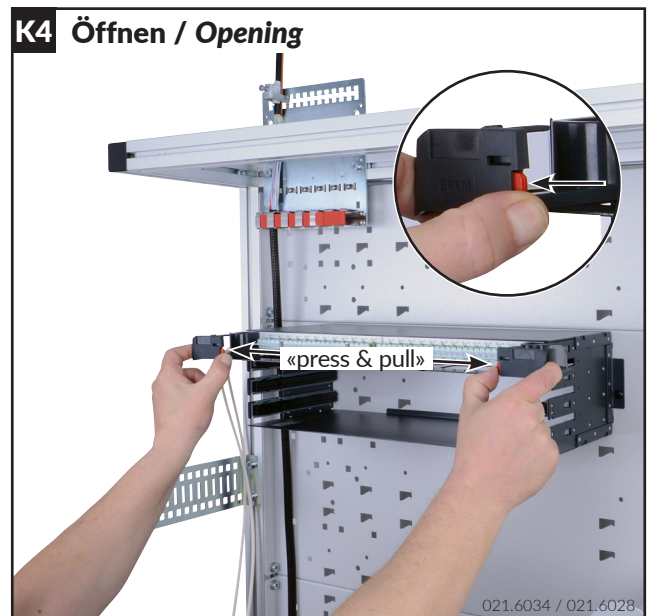
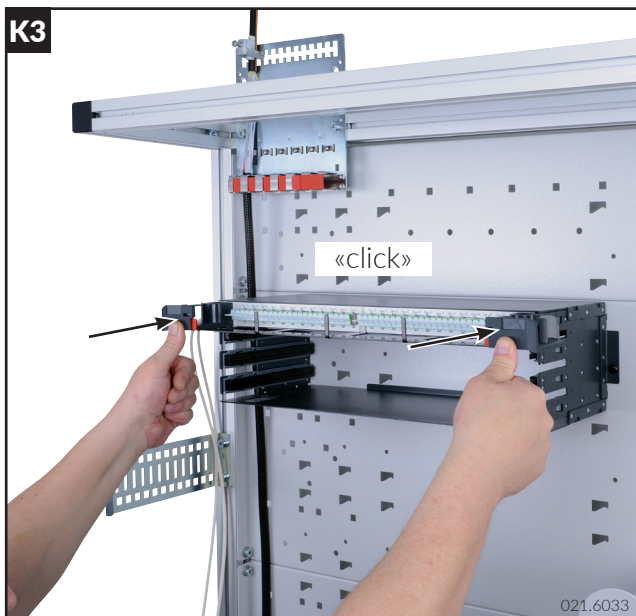
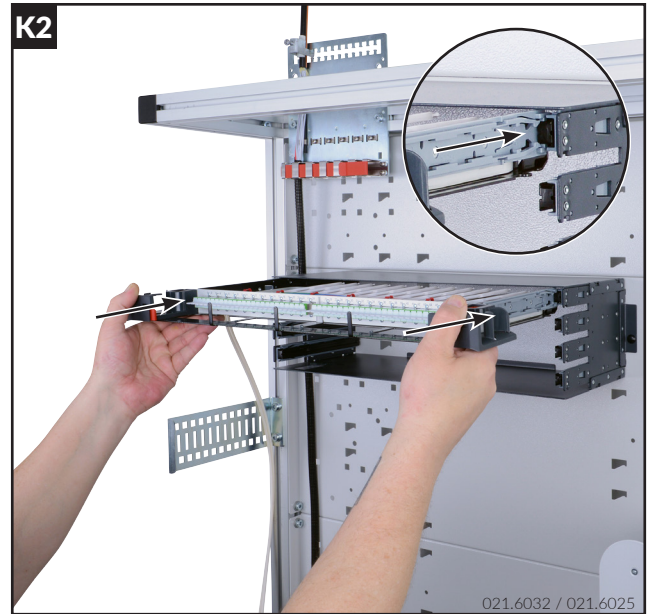
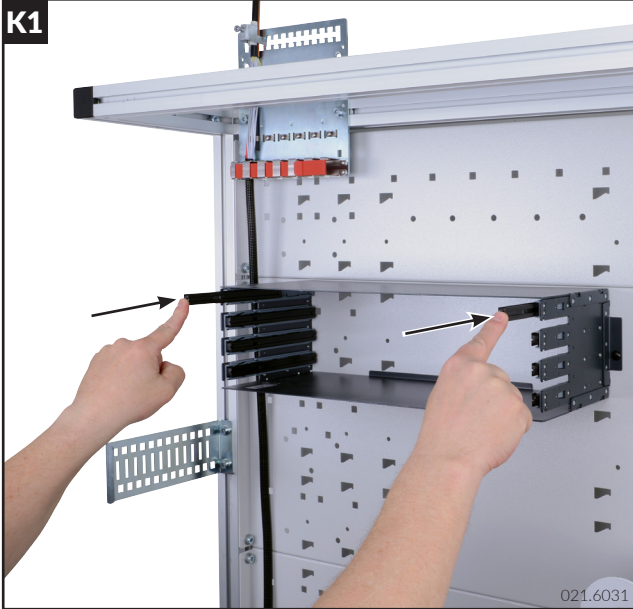

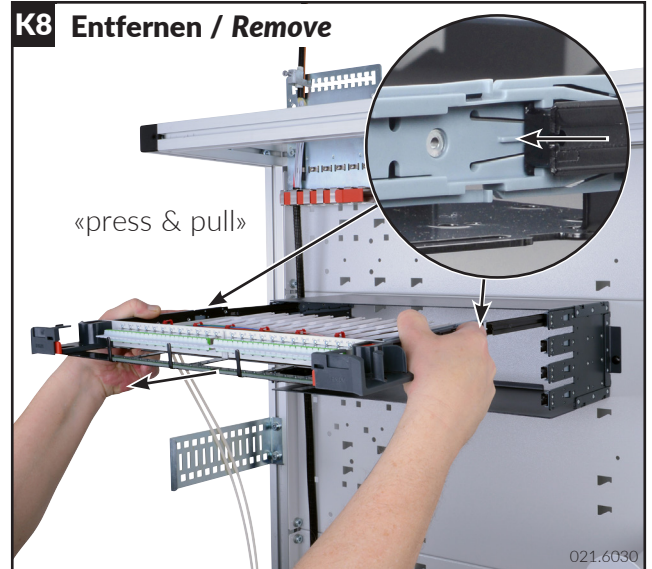
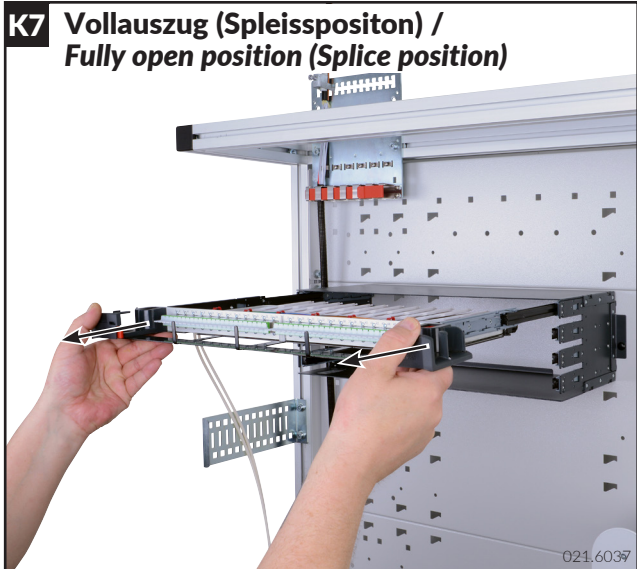

L - Beschriftung / Labeling



Headquarters

Switzerland

Reichle & De-Massari AG

Binzstrasse 32

CHE-8620 Wetzikon

Telephone HQ +41 (0)44 933 81 11

Telefax HQ +41 (0)44 930 49 41

E-Mail hq@rdm.com

www.rdm.com



Please note:

This guide shows the best practices for installation **ONLY**. R&M expressly disclaims all liability for any damage to material, equipment, and for any injury or death. Legal health and safety regulations should have priority over best practices as shown in this guide. R&M does not guarantee this guide to be free of errors. Products included may vary from products shown. Please exercise caution.